

DBE Vendors:

DBE Bidding Opportunity in Hennepin County

Project: France Avenue Multi-Modal Trail Project

Bid Date: Tuesday, April 30, 2019

Bid Time: 11:00 AM

Milestone Dates: Starts June 10th, 2019, 135 Working Days

Contractor: Max Steining, Inc.

DBE Goal: DBE 12.6%

Your proposals are due by: 5pm, Monday 4/29/19

Max Steining, Inc. is bidding this project as a prime contractor and is soliciting qualified bidders for DBE participation. To assist, we have attached the following documents:

- Bid form
- Plan title sheet
- Copy of Ad
- Scope of work
- Summary of work

Max Steining, Inc. is an Equal Opportunity Employer and encourages participation from all certified DBE subcontractors and suppliers.

For the benefit of all contractors we have scanned plans on a hosting site called www.questcdn.com.

Questcdn is a reputable member only website that allows subcontractors to get plans online by paying a small fee of \$10.00. Once you download plans, all addendums when posted will also be available for you to download.

-Below are the steps to obtain a copy of the plans

Plans and Specs are available online at QuestCDN.com. Paper copies are also available in our office.

- Sign in using your QuestCDN login.
- Next step is to click on PROJECTS. Then click SEARCH PROJECTS.

- It will ask for a Quest EDOC# to locate bidding documents.

Enter **Quest EDOC # 6285804**

Password: **82**

Also, the plans can be obtained through the Dropbox link below with no additional costs.

If you use the Dropbox link to get plans and specs for this project, please be warned that it is your responsibility to contact us for any future addendums that are issued from the time of receipt of this email to the bid date and time. While the QuestCDN hosting site is automatically updated with any issued addendums, the Dropbox link does not stay updated with addendums.

Dropbox Link to Access Bidding Documents:

https://www.dropbox.com/sh/28cf2rmcezplkvz/AACAQXSczxqc_fw_eEMoZuMsa?dl=0

If you have any questions in obtaining a copy of the plans **call Quest CDN at 952-233-1632**. Also if you would like to get a copy from our office please know that they are available for you to copy. Kindly call ahead at **651-454-6620** so we can make sure someone is there to assist when you visit. We have reached your firm because it is listed in the MNUCP business category.

Last but not least:

If you need assistance with Bonding, lines of credit- please contact our office for assistance in this area.

If you need assistance in locating equipment and supplies to prepare your quote for this project, please contact our office.

If you need technical assistance in preparing your quote in accordance with the Plans and Specifications, please contact our office.

We also request that all potential vendors solicited kindly send a response back via email or via fax to our office referencing this particular project if this is of interest to you and will you be quoting or not highlighting the type of work you will be quoting.

Thanks in advance,

Estimating Staff

Max Steininger Inc.
3080 Lexington Ave. S.
Eagan, MN 55121
[651-454-6620 \(o\)](tel:651-454-6620)
[651-454-6716 \(f\)](tel:651-454-6716)

MINNESOTA DEPARTMENT OF TRANSPORTATION CITY OF BLOOMINGTON, ENGINEERING DIVISION

CONSTRUCTION PLAN FOR FRANCE AVENUE MULTI-MODAL TRAIL PROJECT

STORM SEWER, WATERMAIN, GRADING, BASE, BITUMINOUS SURFACE, CURB AND GUTTER, SIDEWALK, RETAINING WALL, BOARDWALK, TRAFFIC SIGNAL REVISION AND LIGHTING

LEGEND

EXISTING	PROPOSED
CENTER LINE	---
RIGHT OF WAY LINE	---
PROPERTY LINE	---
PERM. EASEMENT LINE	---
TEMP. EASEMENT LINE	---
EDGE OF ASPHALT	---
CURB & GUTTER LINE	---
REMOVE CURB AND GUTTER	---
REM AND REPLACE C & G	---
SEWER LINE	---
SEWER SERVICE LINE	---
STORM SEWER	---
WATER LINE	---
WATER SERVICE LINE	---
WATER SRVC. LINE (ABAN.)	---
CATV LINE	---
GAS LINE	---
OVERHEAD ELECTRIC	---
FIBER OPTIC	---
UNDERGROUND ELECTRIC	---
TELEPHONE CABLE	---
UTILITY POLE	---
LIGHT POLE	---
UTILITY POLE W/ LIGHT	---
GUY WIRE	---
MANHOLE; STORM, SAN.	---
CATCH BASIN	---
HYDRANT	---
WATER VALVE	---
WATER VALVE IN MANHOLE	---
RAILROAD	---
CONIFEROUS TREE	---
DECIDUOUS TREE	---
CLEAR AND GRUB (TREE)	---
HEDGE	---
PED. CURB RAMP	---
TRAFFIC SIGNAL	---
BLOCK RETAINING WALL	---
WOOD RETAINING WALL	---
TREE LINE	---
CHAIN LINK FENCE	---
WOOD FENCE	---
WIRE FENCE	---
SEDIMENT CONTROL LOG	---
INLET PROTECTION	---
SANITARY MANHOLE	---
STORM MANHOLE	---
CONCRETE WALK	---
REMOVE CONCRETE WALK	---
BITUMINOUS SURFACE	---
REM. BITUMINOUS SURF.	---
CONCRETE DRIVEWAY	---
CLEAR AND GRUB (ACRE)	---
BOARDWALK	---
SEEDING	---
SODDING	---

LOCATED ON: FRANCE AVENUE (CSAH 17)
FROM W. OLD SHAKOPEE ROAD TO W. 84TH STREET

STATE PROJ. NO. 107-020-069
MINN. PROJ. NO. TA 2719 (082)
CITY PROJ. NO. 2019-201
HENNEPIN COUNTY PROJ. NO. 1754
GROSS LENGTH 16,727.92 (3.168) FEET (MILES)
BRIDGES-LENGTH 2,060.95 (0.390) FEET (MILES)
EXCEPTIONS-LENGTH 0 (0) FEET (MILES)
NET LENGTH REF. 14,666.97 (2.778) FEET (MILES)

DESIGN DESIGNATION (TRAIL) - TIER NO. N/A
Design Speed = 20 mph
Stopping Sight Distance Based On: 4.5 Feet Height Of Eyes And
0.0 Height Of Object
Design Speed Not Achieved At: N/A

PROJECT LOCATION

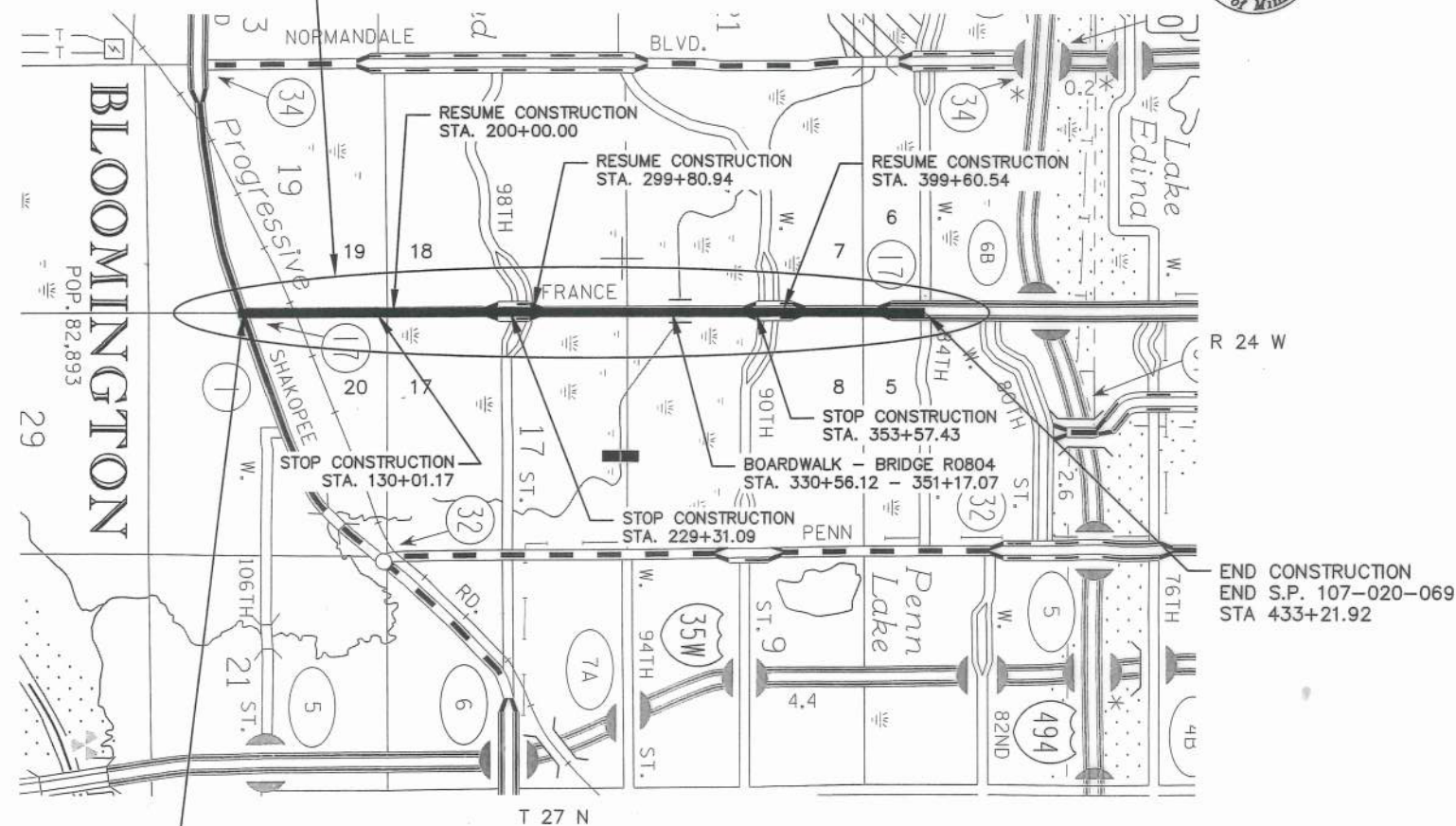

BEGIN CONSTRUCTION
BEGIN S.P. 107-020-069
STA 100+03.16

SCALE IN FEET

PLAN 0 25
PROFILE 0 25 0 2.5
INDEX MAP 0 1,000
HORIZ. VERT.

DATE	SHEET NO.	APPROVED BY

THE SUBSURFACE UTILITY INFORMATION IN THIS PLAN IS UTILITY QUALITY LEVEL D. THE QUALITY LEVEL WAS DETERMINED ACCORDING TO THE GUIDELINES OF CI/ASCE 38-02, ENTITLED "STANDARD GUIDELINES FOR THE COLLECTION AND DEPICTION OF EXISTING SUBSURFACE UTILITY DATA."

MINN. PROJ. NO. TA 2719 (082)

GOVERNING SPECIFICATIONS

THE 2018 EDITION OF THE MINNESOTA DEPARTMENT OF TRANSPORTATION "STANDARD SPECIFICATIONS FOR CONSTRUCTION" SHALL GOVERN.

ALL TRAFFIC CONTROL DEVICES AND SIGNING SHALL CONFORM TO THE MOST RECENT EDITION OF THE MINNESOTA MANUAL ON TRAFFIC CONTROL DEVICES (MMUTCD), INCLUDING "FIELD MANUAL FOR TEMPORARY TRAFFIC CONTROL ZONE LAYOUTS."

INDEX

SHEET NO.	SHEET DESCRIPTION
1	TITLE SHEET
2	GENERAL LAYOUT
3 - 5	STATEMENT OF ESTIMATED QUANTITIES
6	CONSTRUCTION & SOILS NOTES AND INDEX OF TABULATIONS
7 - 8	STANDARD PLATES & EARTHWORK SUMMARY
9 - 12	TABULATIONS
13 - 14	TYPICAL SECTIONS
15 - 16	MISCELLANEOUS DETAILS
17 - 35	STANDARD PLAN SHEETS
36	STAGING AND TRAFFIC CONTROL NOTES
37 - 44	ALIGNMENT PLAN AND TABULATIONS
45 - 56	EXISTING TOPOGRAPHY, UTILITY & REMOVALS PLAN
57 - 81	CONSTRUCTION PLAN & PROFILE
82 - 99	PEDESTRIAN CURB RAMP DETAILS & CURB PROFILES
100 - 105	INTERSECTION DETAILS
106 - 107	RETAINING WALL PLAN AND PROFILE
108 - 111	WATERMAIN PLAN
112 - 115	DRAINAGE PLAN AND DETAILS
116 - 118	STORM WATER POLLUTION PREVENTION PLAN
119 - 130	EROSION CONTROL AND TURF ESTABLISHMENT PLAN
131 - 145	SIGNING & STRIPING PLAN AND DETAILS
146 - 147	WAYFINDING PLAN
148 - 161	TRAFFIC SIGNAL PLANS
162 - 186	CROSS SECTIONS
B1 - B19	BOARDWALK PLAN

THIS PLAN CONTAINS 205 SHEETS

SIGNATURES AND APPROVALS

Design Engineer: I hereby certify that this plan was prepared by me or under my direct supervision, and that I am a duly licensed Professional Engineer under the laws of the State of Minnesota.

Date: 3/26/2019 License Number: 47622

Approved: City of Bloomington Engineer Date: 12/3/2018

Recommended For Approval: Hennepin County Design Division Engineer Date: 3/7/19

Approved: Hennepin County Highway Engineer Date: 3/7/19

District State Aid Engineer: Reviewed for Compliance with State Aid and Federal Aid Rules/Policy Date: 3/22/19

State Aid Engineer: Approved for State Aid and Federal Aid Funding Date: 3/22/19

I HEREBY CERTIFY THAT THE FINAL FIELD REVISIONS, IF ANY, OF THIS PLAN WERE MADE BY ME OR UNDER MY DIRECT SUPERVISION AND THAT I AM A DULY LICENSED PROFESSIONAL ENGINEER UNDER THE LAWS OF THE STATE OF MINNESOTA.

DATE _____ LIC. NO. _____

STATE PROJ. NO. 107-020-069

SHEET 1 OF 186

PROJECT: **France Avenue Multi-Modal Trail Project**

Max Steninger, Inc is planning to submit a Prime Bid on the above Referenced Project and we are requesting bids from qualified bidders.

BID DATE: **4/30/2019**
BID TIME: **11:00 AM**

DBE GOAL: **DBE 12.6%**

YOUR PROPOSALS ARE DUE TO US BY: 5pm, Monday 4/29/19

We also provide you with a line item description of the bid form if available and if you need to break down a scope of work into more economically feasible units, please feel free to do so. We welcome this as it gives us an opportunity to debundle work if needed towards meeting the DBE Goals.

For this project, the specific scope of work that we feel describes the opportunities are checked below:

	Categories	Description of Work
✓	Concrete	Concrete Paving
✓	Concrete	Supplies of Concrete Aggregates
	Concrete	Concrete Repairs
✓	Concrete Bridge	Structural Concrete Bridge/Ret Walls
✓	Concrete Structural	Structural Concrete Miscellaneous
✓	Curb & Walks	Concrete Curbs & Gutter
✓	Curb & Walks	Concrete Walks
	Earth Retention	Engineering for Sheet piling, Shoring
	Earth Retention	H- Piles
	Earth Retention	Sheet Piling
	Earth Retention	Shoring & Sheet Piling
✓	Earthwork	Dewatering
✓	Earthwork	Crushing Of Recycled Aggregates
	Earthwork	Hydraulic Excavation
✓	Earthwork	Supply of Granular & Aggregates
	Electrical	Electrical Airport Related
✓	Electrical	Electrical Lighting
✓	Electrical	Electrical Signal
✓	Electrical	Loop Detectors
✓	Electrical	Supplies of Electrical Materials
✓	Environmental	Environmental testing and Consulting
	Environmental	Haul & Dispose Contaminated Soils
	Environmental	Haul & Dispose Impacted Soils
✓	Erosion Control	Erosion Control- Permanent
✓	Erosion Control	Erosion Control- Temporary
✓	Erosion Control	Hydroseeding Temp
✓	Fencing	Fencing / Bollards
	Field Engineering	As- Built Surveys
✓	Field Engineering	Surveying
	Guardrail	Guardrail
	Milling	Bituminous Milling
✓	Misc	Boardwalks, Decks, Woodwork
✓	Misc	Clean up Vac Trucks
✓	Misc	Flagging- Highway Work
✓	Misc	Lumber Supplies
	Misc	Pilot Car- Airport Secured Area
✓	Misc	Field Office
	Asbestos	Asbestos Abatement

	Categories	Description of Work
	Misc	Pilot Car- Highway Work
✓	Misc	Port-a-Potys
	Misc	Radio Car- Airport Secured Area
	Misc	Site Amenities, Benches, Kiosks
✓	Misc	Supplies of Misc Construction Materials
✓	Misc	Sweeping- Pickup Brooms
	Ornamental	Ornamental Steel
	Pavement Markings	Epoxy- Pavement Markings
✓	Pavement Markings	Paint- Pavement Markings
	Pavement Markings	Poly- Pavement Markings
✓	Pavement Markings	Thermo- Pavement Markings
✓	Paving	Asphalt Paving
✓	Paving	Supplies of Asphalt Materials
	Retaining Walls	Soil Retention Walls
✓	Retaining Walls	Mod Block Walls
	Saw & Seal	Joint Adhesives
✓	Saw & Seal	Saw & Seal Pavement
✓	Sawcutting	Sawcutting
✓	Signage	Permanent Sign Panels
✓	Site Utilities	Castings & Other Misc Structures
✓	Site Utilities	Drainage Structures
✓	Site Utilities	Sanitary
✓	Site Utilities	Storm Sewer
✓	Site Utilities	Watermain
	Steel	Fabricated Steel
✓	Subdrainage	Drain tile
✓	Testing	Moisture & other Geotechnical Testing
	Traffic Control	J Barriers
	Traffic Control	Pavement Marking Removals
✓	Traffic Control	Temp Signage
✓	Traffic Control	Traffic Control
✓	Tree Clearing	Clear & Grub
✓	Trucking	Rubble
✓	Trucking	Aggregates, Misc Earth Materials
✓	Turf Establishment	Hydroseeding Permanent
✓	Turf Establishment	Seeding
✓	Turf Establishment	Sodding
✓	Landscaping	Trees, Plantings, Soils for Planting Medium

CITY OF BLOOMINGTON, ENGINEERING DIVISION
1700 W 98TH STREET, BLOOMINGTON, MN 55431

*****PROPOSAL*****

FOR CONSTRUCTION OF THE FRANCE AVENUE MULTI-MODAL TRAIL PROJECT

BIDS RECEIVED UNTIL ELEVEN O'CLOCK A.M. ON TUESDAY, APRIL 30, 2019

PROPOSAL OF

(NAME OF FIRM)

(ADDRESS)

(AREA CODE) TELEPHONE NUMBER

TO FURNISH AND DELIVER ALL MATERIALS AND TO PERFORM ALL WORK IN ACCORDANCE WITH THE CONTRACT, THE PLANS AND THE APPROVED DEPARTMENT OF TRANSPORTATION "STANDARD SPECIFICATIONS FOR CONSTRUCTION," 2018 EDITION, EXCEPT AS STATED OTHERWISE IN THE SPECIAL PROVISIONS WHICH ARE PART OF THIS PROPOSAL, FOR

STATE PROJECT NO. 107-020-069

MINNESOTA PROJECT NO. TA 2719 (082)

LOCATION: FRANCE AVENUE FROM W OLD SHAKOPEE ROAD TO W 84TH STREET

TYPE OF WORK: STORM SEWER, WATERMAIN, GRADING, BASE, BITUMINOUS SURFACE, CURB AND GUTTER, SIDEWALK, RETAINING WALL, BOARDWALK, TRAFFIC SIGNAL REVISION AND LIGHTING

LENGTH: 3.16 MILES

STARTING DATE: JUNE 10, 2019

WORKING DAYS: 135

NOTICE TO BIDDERS: In submitting a bid, you must return this complete proposal. You must initial changes made in the Schedule of Prices in the Proposal and acknowledge addenda on the back cover sheet.

I certify that this Proposal was prepared by me or under my direct supervision, and that I am a licensed professional engineer under the laws of the State of Minnesota.

Steven B. Pusch
License Number 47622

Date: 3/28/19

APPROVED

John M. Jorg
City Engineer

Date: 12/3/18

BID RIGGING IS A SERIOUS CRIME. IF YOU HAVE ANY INFORMATION CONCERNING COLLUSIVE BIDDING, EVEN A REQUEST TO SUBMIT A COMPLIMENTARY BID, PLEASE CALL THE MINNESOTA ATTORNEY GENERAL'S OFFICE AT TELE. NO. 651-296-1796

2019-201 FRANCE AVENUE MULTI-MODAL TRAIL PROJECT

SP 107-020-069, MN TA 2719 (082)

PROPOSAL FORM

<u>ITEM NO.</u>	<u>ITEM DESCRIPTION</u>	<u>UNIT</u>	<u>ESTIMATED</u>	<u>UNIT PRICE</u>	<u>EXTENSION</u>
2021.501	MOBILIZATION	LUMP SUM	1.0		
2041.610	TRAINEES	HOUR	900	\$1.00	\$900.00
2101.505	GRUBBING	ACRE	0.7		
2101.524	CLEARING	TREE	12		
2101.524	GRUBBING	TREE	25		
2102.503	PAVEMENT MARKING REMOVAL	LIN FT	200		
2102.518	PAVEMENT MARKING REMOVAL	SQ FT	800		
2104.502	REMOVE PIPE APRON	EACH	2		
2104.502	REMOVE CASTING	EACH	9		
2104.502	REMOVE GATE VALVE & BOX	EACH	6		
2104.502	REMOVE DRAINAGE STRUCTURE	EACH	10		
2104.502	REMOVE SIGN TYPE C	EACH	11		
2104.502	SALVAGE HYDRANT	EACH	6		
2104.502	SALVAGE LIGHTING UNIT	EACH	1		
2104.502	SALVAGE SIGN TYPE C	EACH	53		
2104.503	SAWING CONCRETE PAVEMENT (FULL DEPTH)	LIN FT	400		
2104.503	SAWING BITUMINOUS PAVEMENT (FULL DEPTH)	LIN FT	4580		
2104.503	REMOVE WATERMAIN	LIN FT	27		
2104.503	REMOVE PIPE SEWERS	LIN FT	251		
2104.503	REMOVE CURB & GUTTER	LIN FT	3980		

2019-201 FRANCE AVENUE MULTI-MODAL TRAIL PROJECT

SP 107-020-069, MN TA 2719 (082)

PROPOSAL FORM

<u>ITEM NO.</u>	<u>ITEM DESCRIPTION</u>	<u>UNIT</u>	<u>ESTIMATED</u>	<u>UNIT PRICE</u>	<u>EXTENSION</u>
2104.503	REMOVE FENCE	LIN FT	60		
2104.503	SALVAGE FENCE	LIN FT	100		
2104.504	REMOVE CONCRETE WALK	SQ YD	5860		
2104.504	REMOVE BITUMINOUS PAVEMENT	SQ YD	11480		
2106.507	EXCAVATION - COMMON	CU YD	5079		
2106.507	EXCAVATION - MUCK	CU YD	804		
2106.507	SELECT GRANULAR EMBANKMENT MOD 10% (CV)	CU YD	7.4		
2106.507	COMMON EMBANKMENT (CV)	CU YD	3192		
2123.610	STREET SWEEPER (WITH PICKUP BROOM)	HOURL	20		
2211.507	AGGREGATE BASE (CV) CLASS 5	CU YD	2610		
2301.602	DRILL & GROUT REINFORCEMENT BAR (EPOXY COATED)	EACH	94		
2357.506	BITUMINOUS MATERIAL FOR TACK COAT	GAL	160		
2360.509	TYPE SP 12.5 WEARING COURSE MIXTURE (2,B)	TON	2390		
2360.509	TYPE SP 12.5 NON WEARING COURSE MIXTURE (3,C)	TON	280		
2360.509	TYPE SP 12.5 WEARING COURSE MIXTURE (4,B)	TON	380		
2401.507	STRUCTURE EXCAVATION CLASS E	CU YD	7.4		
2401.507	STRUCTURAL CONCRETE (3B52)	CU YD	1.8		
2403.522	TREATED WOOD	MBM	135.8		
2403.603	TIMBER RAILING	LIN FT	4190		
2411.618	PREFABRICATED MODULAR BLOCK WALL	SQ FT	230		

2019-201 FRANCE AVENUE MULTI-MODAL TRAIL PROJECT

SP 107-020-069, MN TA 2719 (082)

PROPOSAL FORM

<u>ITEM NO.</u>	<u>ITEM DESCRIPTION</u>	<u>UNIT</u>	<u>ESTIMATED</u>	<u>UNIT PRICE</u>	<u>EXTENSION</u>
2451.507	FINE AGGREGATE BEDDING (CV)	CU YD	35.2		
2452.502	CIP CONCRETE TEST PILE 70 FT LONG 12"	EACH	6		
2452.603	CIP CONCRETE PILING - 12"	LIN FT	12480		
2479.518	INORGANIC ZINC-RICH PAINT SYSTEM (SHP&FLD)	SQ FT	5781		
2501.502	15" RC PIPE APRON	EACH	2		
2503.503	15" RC PIPE SEWER DESIGN 3006 CLASS V	LIN FT	254		
2503.602	CONNECT TO EXISTING STORM SEWER	EACH	5		
2503.602	CONNECT INTO EXISTING DRAINAGE STRUCTURE	EACH	2		
2504.601	REVISE IRRIGATION SYSTEM	LUMP SUM	1		
2504.602	CONNECT TO EXISTING WATERMAIN	EACH	6		
2504.602	INSTALL HYDRANT	EACH	6		
2504.602	ADJUST VALVE BOX-WATER	EACH	4		
2504.602	6" GATE VALVE & BOX	EACH	5		
2504.602	ADJUST CURB BOX	EACH	1		
2504.602	INTERNAL CHIMNEY MANHOLE SEAL	EACH	4		
2504.602	RECONSTRUCT SANITARY MANHOLES	EACH	4		
2504.603	6" WATERMAIN DUCTILE IRON CL 52	LIN FT	78		
2504.603	WATERMAIN ENCASEMENT	LIN FT	131		
2504.604	WATERMAIN INSULATION	SQ YD	6		
2504.608	WATERMAIN FITTINGS	POUND	378		

2019-201 FRANCE AVENUE MULTI-MODAL TRAIL PROJECT

SP 107-020-069, MN TA 2719 (082)

PROPOSAL FORM

<u>ITEM NO.</u>	<u>ITEM DESCRIPTION</u>	<u>UNIT</u>	<u>ESTIMATED</u>	<u>UNIT PRICE</u>	<u>EXTENSION</u>
2506.502	CONSTRUCT DRAINAGE STRUCTURE DESIGN F	EACH	3		
2506.502	CONSTRUCT DRAINAGE STRUCTURE DESIGN G	EACH	3		
2506.502	CONST DRAINAGE STRUCTURE DESIGN H	EACH	9		
2506.502	CASTING ASSEMBLY	EACH	24		
2506.602	ADJUST FRAME & RING CASTING	EACH	4		
2511.504	GEOTEXTILE FILTER TYPE 4	SQ YD	36		
2511.507	RANDOM RIPRAP CLASS II	CU YD	6.8		
2521.518	6" CONCRETE WALK	SQ FT	13545		
2521.618	TIMBER WALK	SQ FT	27300		
2531.503	CONCRETE CURB AND GUTTER DESIGN B612	LIN FT	490		
2531.503	CONCRETE CURB AND GUTTER DESIGN B618	LIN FT	410		
2531.503	CONCRETE CURB AND GUTTER DESIGN B624	LIN FT	2850		
2531.503	CONCRETE CURB DESIGN V6	LIN FT	100		
2531.504	8" CONCRETE DRIVEWAY PAVEMENT	SQ YD	350		
2531.618	TRUNCATED DOMES	SQ FT	992		
2564.602	WAYFINDING SIGN	EACH	5		
2564.602	WAYFINDING KIOSK	EACH	1		
2545.602	INSTALL LIGHTING UNIT	EACH	1		
2554.502	GUIDE POST TYPE B	EACH	2		
2557.603	INSTALL FENCE	LIN FT	100		

2019-201 FRANCE AVENUE MULTI-MODAL TRAIL PROJECT

SP 107-020-069, MN TA 2719 (082)

PROPOSAL FORM

<u>ITEM NO.</u>	<u>ITEM DESCRIPTION</u>	<u>UNIT</u>	<u>ESTIMATED</u>	<u>UNIT PRICE</u>	<u>EXTENSION</u>
2563.601	TRAFFIC CONTROL SUPERVISOR	LUMP SUM	1.0		
2563.601	TRAFFIC CONTROL	LUMP SUM	1.0		
2564.502	INSTALL SIGN TYPE C	EACH	53		
2564.518	SIGN PANELS TYPE C	SQ FT	59.6		
2565.602	ADJUST HANDHOLE	EACH	2		
2565.616	REVISE SIGNAL SYSTEM A	SYSTEM	1		
2565.616	REVISE SIGNAL SYSTEM B	SYSTEM	1		
2565.616	REVISE SIGNAL SYSTEM C	SYSTEM	1		
2571.524	CONIFEROUS TREE 5' HT B&B	TREE	1		
2571.524	DECIDUOUS TREE 3" CAL B&B	TREE	20		
2573.501	STABILIZED CONSTRUCTION EXIT	LUMP SUM	1		
2573.502	STORM DRAIN INLET PROTECTION	EACH	53		
2573.503	FLOTATION SILT CURTAIN TYPE MOVING WATER	LIN FT	45		
2573.503	SEDIMENT CONTROL LOG TYPE STRAW	LIN FT	16610		
2573.602	EROSION CONTROL SUPERVISOR	LUMP SUM	1.0		
2574.508	FERTILIZER TYPE 3	POUND	1820		
2574.508	FERTILIZER TYPE 4	POUND	65		
2575.504	SODDING TYPE LAWN	SQ YD	430		
2575.504	EROSION CONTROL BLANKETS CATEGORY 3N	SQ YD	190		
2575.505	SEEDING	ACRE	5.5		

2019-201 FRANCE AVENUE MULTI-MODAL TRAIL PROJECT

SP 107-020-069, MN TA 2719 (082)

PROPOSAL FORM

<u>ITEM NO.</u>	<u>ITEM DESCRIPTION</u>	<u>UNIT</u>	<u>ESTIMATED</u>	<u>UNIT PRICE</u>	<u>EXTENSION</u>
2575.508	SEED MIXTURE 25-131	POUND	1050		
2575.508	SEED MIXTURE 33-261	POUND	15		
2575.508	HYDRAULIC STABILIZED FIBER MATRIX	POUND	14230		
2575.523	RAPID STABILIZATION METHOD 3	M GALLON	12		
2582.503	4" SOLID LINE MULTI-COMPONENT	LIN FT	2315		
2582.503	4" BROKEN LINE MULTI-COMPONENT	LIN FT	3050		
2582.503	12" SOLID LINE PREFORM THERMO GROUND IN	LIN FT	20		
2582.518	PAVEMENT MESSAGE PREFORM THERMOPLASTIC GROUND IN	SQ FT	50		
2582.518	CROSSWALK PAINT GROUND IN	SQ FT	1140		

2019-201 PROJECT TOTAL = _____