

## **DBE Vendors:**

### **DBE Bidding Opportunity in Scott County**

**Project:** T. H. 13/CSAH 21 Downtown Reconstruction

**Bid Date:** 6/17/2019

**Bid Time:** 10:00 AM

**Completion Dates:** Dec 20th, 2019

**Contractor:** Max Steininger, Inc.

**DBE Goal:** DBE 17%

**Your proposals are due by: 5pm, Friday 6/14/19**

Max Steininger Inc. is bidding this project as a prime contractor and is soliciting qualified bidders for DBE participation. To assist, we have attached the following documents:

- Bid form
- Plan title sheet
- Copy of Ad
- Scope of work
- Summary of work

Max Steininger, Inc. is an Equal Opportunity Employer and encourages participation from all certified DBE subcontractors and suppliers.

For the benefit of all contractors we have scanned plans on a hosting site called [www.questcdn.com](http://www.questcdn.com).

Questcdn is a reputable member only website that allows subcontractors to get plans online by paying a small fee of \$10.00. Once you download plans, all addendums when posted will also be available for you to download.

-Below are the steps to obtain a copy of the plans

Plans and Specs are available online at QuestCDN.com. Paper copies are also available in our office.

- Sign in using your QuestCDN login.

- Next step is to click on PROJECTS. Then click SEARCH PROJECTS.
- It will ask for a Quest EDOC# to locate bidding documents.

Enter **Quest EDOC # 6377489**  
Password: **82**

Also, the plans can be obtained through the Dropbox link below with no additional costs.

If you use the Dropbox link to get plans and specs for this project, please be warned that it is your responsibility to contact us for any future addendums that are issued from the time of receipt of this email to the bid date and time. While the QuestCDN hosting site is automatically updated with any issued addendums, the Dropbox link does not stay updated with addendums.

### **Dropbox Link to Access Bidding Documents:**

**<https://www.dropbox.com/sh/8kxzhw73myqpsvj/AADhD7vi7RFICXhYSiAIUk0na?dl=0>**

If you have any questions in obtaining a copy of the plans **call Quest CDN at 952-233-1632**. Also if you would like to get a copy from our office please know that they are available for you to copy. Kindly call ahead at **651-454-6620** so we can make sure someone is there to assist when you visit. We have reached your firm because it is listed in the MNUCP business category.

Last but not least:

If you need assistance with Bonding, lines of credit- please contact our office for assistance in this area.

If you need assistance in locating equipment and supplies to prepare your quote for this project, please contact our office.

If you need technical assistance in preparing your quote in accordance with the Plans and Specifications, please contact our office.

**We also request that all potential vendors solicited kindly send a response back via email or via fax to our office referencing this particular project if this is of interest to you and will you be quoting or not highlighting the type of work you will be quoting.**

Thanks in advance,

Estimating Staff

Max Steining Inc.  
3080 Lexington Ave. S.  
Eagan, MN 55121  
[651-454-6620 \(o\)](tel:6514546620)  
[651-454-6716 \(f\)](tel:6514546716)

# PLAN SYMBOLS

STATE LINE  
COUNTY LINE  
TOWNSHIP OR RANGE LINE  
SECTION LINE  
QUARTER LINE  
RIGHT-OF-WAY LINE  
RIGHT-OF-WAY LINE  
PRESENT RIGHT-OF-WAY LINE

TRUCK HIGHWAY CENTER LINE  
RETAINING WALL  
RAILROAD  
RAILROAD RIGHT-OF-WAY LINE  
DRAIN TILE  
CULVERT  
DROP INLET  
GUARD RAIL  
CHAIN LINK FENCE  
STONE WALL OR FENCE  
HEDGE  
RAILROAD CROSSING SIGN  
RAILROAD CROSSING SIGN  
ELECTRIC WARNING SIGN  
CROSSING GATE  
MARSH/SWAMP

TUBER  
DRAINAGE  
BRUSH  
NURSERY  
OVERPASS (Highway Over)  
UNDERPASS (Highway Under)  
BRIDGE  
IRON PIPE OR RCD  
MONUMENT (STONE, CONCRETE, OR METAL)  
WOODEN JUMP  
BENCHMARK

## UTILITY SYMBOLS

POWER POLE LINE  
TELEPHONE OR TELEGRAPH  
POLE LINE  
JOINT TELEPHONE AND POWER  
ON POWER POLES  
ON TELEPHONE POLES  
ANCHOR  
STREET LIGHT  
PNEUMATIC TELEPHONE CABLE  
TERMINAL  
GAS MAIN  
WATER MAIN  
CONDUIT  
TELEPHONE CABLE IN CONDUIT  
ELECTRIC CABLE IN CONDUIT  
TELEPHONE HANDPOLE  
ELECTRIC HANDPOLE  
BURIED TELEPHONE CABLE  
BURIED ELECTRIC CABLE  
SEWER (SANITARY)  
SEWER (STORM)  
SEWER HANDPOLE  
HANDPOLE  
CATCH BASIN  
FIRE HYDRANT

AGREEMENT NO. 1031080  
SCOTT COUNTY  
S.P. 7001-127 (T.H. 13 = 117)  
FEDERAL FUNDS  
METRO DISTRICT

INDEX MAP 0' 2000'  
GENERAL LAYOUT 0' 300'  
PLAN 0' 50'  
PROFILE 0' 50' HORIZ. 10' VERT.  
CROSS-SECTION 0' 20' HORIZ. 20' VERT.

THE SUBSURFACE UTILITY INFORMATION IN THIS PLAN IS UTILITY QUALITY LEVEL 0. THIS QUALITY LEVEL WAS DETERMINED ACCORDING TO THE GUIDELINES OF C1/ASCE 38-02 ENTITLED "STANDARD GUIDELINES FOR THE COLLECTION AND DEPICTION OF EXISTING SUBSURFACE UTILITY DATA."

DATE	SHEET NO.	APPROVED BY

# MINNESOTA DEPARTMENT OF TRANSPORTATION SCOTT COUNTY

CONSTRUCTION PLAN FOR GRADING, CONCRETE & BITUMINOUS PAVEMENT, ADA IMPROVEMENTS,  
LIGHTING, GEOFOAM & ROUNDABOUTS & SIGNAL REVISIONS  
LOCATED ON T.H. 13 FROM 0.07 MILES NORTH OF FRANKLIN TRAIL SE TO 0.10 MILES NORTH OF DAKOTA ST SE  
AND ON C.S.A.H. 21 FROM 0.03 MILES WEST OF WEST AVE SE TO 0.08 MILES WEST OF FRANKLIN TRAIL SE

STATE PROJ. NO. 7001-127 (T.H. 13)  
GROSS LENGTH 2865.69 FEET 0.543 MILES  
BRIDGES-LENGTH FEET MILES  
EXCEPTIONS-LENGTH FEET MILES  
NET LENGTH 2865.69 FEET 0.543 MILES  
REF. POINT 085+00.004 TO REF. POINT 085+00.530

STATE PROJ. NO. 201-101-006 (DULUTH AVE SE)  
GROSS LENGTH 194.69 FEET 0.037 MILES  
BRIDGES-LENGTH FEET MILES  
EXCEPTIONS-LENGTH FEET MILES  
NET LENGTH 194.69 FEET 0.037 MILES  
REF. POINT TO REF. POINT

STATE PROJ. NO. 201-130-002 (ARCADIA AVE)  
GROSS LENGTH 387.06 FEET 0.073 MILES  
BRIDGES-LENGTH FEET MILES  
EXCEPTIONS-LENGTH FEET MILES  
NET LENGTH 387.06 FEET 0.073 MILES  
REF. POINT TO REF. POINT

NOTE: LENGTH AND DESCRIPTION BASED ON T.H. 13 NB AND C.S.A.H. 21 EB ALIGNMENT.  
PROJECT LOCATION: TOWNSHIP T114N, RANGE R22W, SECTION 2.

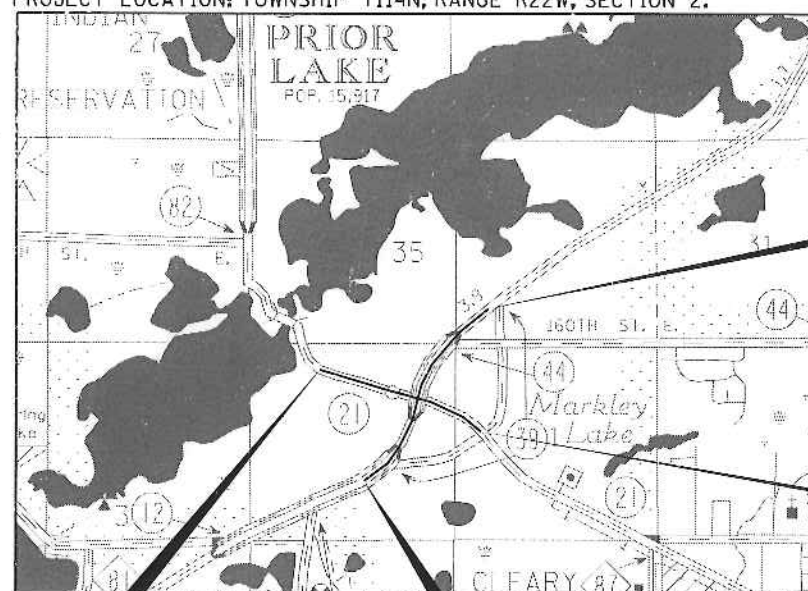

BEGIN S.P. 070-621-032  
C.S.A.H. 21 EB  
STA. 71+00.00  
BEGIN S.P. 7001-127  
T.H. 13 NB  
STA. 1250+05.34

STATE PROJ. NO. 070-621-032 (C.S.A.H. 21)  
GROSS LENGTH 4925.00 FEET 0.933 MILES  
BRIDGES-LENGTH FEET MILES  
EXCEPTIONS-LENGTH FEET MILES  
NET LENGTH 4925.00 FEET 0.933 MILES  
REF. POINT TO REF. POINT

STATE PROJ. NO. 7001-127  
CHARGE IDENTIFIER  
070-621-032

DULUTH AVE SE DESIGN DESIGNATION  
S.P. 201-101-006  
FUNCTIONAL CLASS: MINOR COLLECTOR  
DESIGN ESALS 2039 = 496,600  
ADT (Current Year) 2019 = 3,900  
ADT (Future Year) 2039 = 4,600  
R VALUE (20) = 10 TON DESIGN  
T (Heavy Commercial) = 5.0%  
No. of Traffic Lanes: 2  
No. of Parking Lanes: 2  
Shoulder Width: 10'

ARCADIA AVE DESIGN DESIGNATION  
S.P. 201-130-002  
FUNCTIONAL CLASS: MINOR COLLECTOR  
DESIGN ESALS 2039 = 316,300  
ADT (Current Year) 2019 = 2,600  
ADT (Future Year) 2039 = 2,800  
R VALUE (20) = 10 TON DESIGN  
T (Heavy Commercial) = 5.0%  
No. of Traffic Lanes: 2  
No. of Parking Lanes: 0  
Shoulder Width: 10'

T.H. 13 DESIGN DESIGNATION  
S.P. 7001-127  
FUNCTIONAL CLASS: MINOR ARTERIAL  
DESIGN ESALS 2039 = 1,896,200  
ADT (Current Year) 2019 = 16,100  
ADT (Future Year) 2039 = 18,400  
R VALUE (20) = 10 TON DESIGN  
T (Heavy Commercial) = 4.2%  
No. of Traffic Lanes: 2  
No. of Parking Lanes: 0  
Shoulder Width: 10'

C.S.A.H. 21 DESIGN DESIGNATION  
S.P. 070-621-032  
FUNCTIONAL CLASS: MINOR ARTERIAL  
DESIGN ESALS 2039 = 959,700  
ADT (Current Year) 2019 = 12,800  
ADT (Future Year) 2039 = 20,000  
R VALUE (20) = 10 TON DESIGN  
T (Heavy Commercial) = 5.0%  
No. of Traffic Lanes: 2  
No. of Parking Lanes: 0  
Shoulder Width: 10'

FED. PROJ. NO. STPF 7019 (171)

## GOVERNING SPECIFICATIONS

THE 2018 EDITION OF THE MINNESOTA DEPARTMENT OF TRANSPORTATION "STANDARD SPECIFICATIONS FOR CONSTRUCTION" SHALL GOVERN.

ALL TRAFFIC CONTROL DEVICES SHALL CONFORM TO THE LATEST EDITION OF THE "MINNESOTA MANUAL ON UNIFORM TRAFFIC CONTROL DEVICES" (MUTCD), INCLUDING THE LATEST FIELD MANUAL FOR TEMPORARY TRAFFIC CONTROL ZONE LAYOUTS.

SHEET NO.	INDEX
1	TITLE SHEET
2	GENERAL LAYOUT
3-7	STATEMENT OF ESTIMATED QUANTITIES
8-10	EARTHWORK SUMMARY & TABULATION
11-16	QUANTITY TABULATIONS
17	CONSTRUCTION NOTES & STANDARD PLATES
18-47, 48A-48C, 49-55	STANDARD PLANS
56-65	TYPICAL SECTIONS
66-72	MISCELLANEOUS DETAILS
73-81	UTILITY TABULATIONS
82-86	ALIGNMENT PLAN
87-97	EXISTING CONDITIONS
98-108	RIGHT OF WAY PLAN
109-119	REMOVAL PLAN
120-133	CONSTRUCTION PLAN & PROFILE
134-139	CONSTRUCTION PROFILES
140-150	INTERSECTION DETAILS
151-162	DRAINAGE PLAN
163-170	DRAINAGE PROFILES
171-175	DRAINAGE TABULATIONS
176-177	DRAINAGE DETAILS
178-186	SANITARY SEWER & WATER
187-191	GRADING PLAN
192-194	STORMWATER POLLUTION PREVENTION PLAN

206-216	TURF ESTABLISHMENT AND SUPERELEVATION PLAN
217-225	PREFABRICATED MODULAR BLOCK WALL PLAN
226-237	SIGNAL PLAN
238-249	INTERCONNECT PLAN
250-274	LIGHTING PLAN
275-319	SIGNING & STRIPING PLAN
320-352	STAGING & TRAFFIC CONTROL PLAN
353-376	STREETSCAPE PLAN
377-380	IRRIGATION PLAN
381	CROSS SECTION WATCHLINE LAYOUT
XS1-XS29	CROSS SECTIONS C.S.A.H. 21 (SETTLEMENT)
XS30-XS48	CROSS SECTIONS C.S.A.H. 21
XS49-XS51	CROSS SECTIONS T.H. 13
XS52-XS53	CROSS SECTIONS DULUTH AVE SE

THIS PLAN CONTAINS 432 SHEETS

SHEETS 195 - 205  
HAVE BEEN DELETED.



1222 NICOLL STREET  
BURNSVILLE, MINNESOTA 55337  
Phone: (952) 890-0509  
Email: burns@bolton-menk.com  
www.bolton-menk.com

I HEREBY CERTIFY THAT THIS PLAN WAS PREPARED BY ME OR UNDER MY DIRECT SUPERVISION AND THAT I AM A DULY LICENSED PROFESSIONAL ENGINEER UNDER THE LAWS OF THE STATE OF MINNESOTA.

PRINT NAME: DEREK J. ARENS LICENSE # 52673  
DATE: 03-22-2019 SIGNATURE: Derek J. Arens

RECOMMENDED FOR APPROVAL  
CITY OF PRIOR LAKE CITY ENGINEER 3/26/2019  
RECOMMENDED FOR APPROVAL  
SCOTT COUNTY ENGINEER 3/26/2019  
RECOMMENDED FOR APPROVAL  
DISTRICT TRANSPORTATION ENGINEER 4/1/2019  
RECOMMENDED FOR APPROVAL  
DISTRICT MATERIALS ENGINEER 3/26/2019  
RECOMMENDED FOR APPROVAL  
WATER RESOURCES/HYDRAULICS ENGINEER 3-27-19  
RECOMMENDED FOR APPROVAL  
DISTRICT TRAFFIC ENGINEER 3/27/19  
RECOMMENDED FOR APPROVAL  
STATE PRE-LETTING ENGINEER 5/3/2019  
OFFICE OF LAND MANAGEMENT APPROVAL  
DISTRICT LAND MANAGEMENT 5/3/2019  
APPROVED  
STATE DESIGN ENGINEER 3/26/2019  
DISTRICT STATE AID ENGINEER REVIEWED FOR COMPLIANCE WITH STATE AND FEDERAL AID RULES/POLICY  
APPROVED FOR STATE AND FEDERAL AID FUNDING: STATE AID ENGINEER 3/26/2019

S.P. 7001-127 (T.H. 13 = 117), S.P. 070-621-032, S.P. 201-101-006, S.P. 201-130-002, C.P. 21-34

SHEET NO. 1 OF 381

PROJECT: **T. H. 13/CSAH 21 Downtown Reconstruction**

Max Steninger, Inc is planning to submit a Prime Bid on the above Referenced Project and we are requesting bids from qualified bidders.

BID DATE: **6/17/2019**  
BID TIME: **10:00 AM**

DBE GOAL: **DBE 17%**

**YOUR PROPOSALS ARE DUE TO US BY: 5pm, Friday 6/14/19**

We also provide you with a line item description of the bid form if available and if you need to break down a scope of work into more economically feasible units, please feel free to do so. We welcome this as it gives us an opportunity to debundle work if needed towards meeting the DBE Goals.

For this project, the specific scope of work that we feel describes the opportunities are checked below:

	<b>Categories</b>	<b>Description of Work</b>
✓	Concrete	Concrete Paving
✓	Concrete	Supplies of Concrete Aggregates
✓	Concrete	Concrete Repairs
	Concrete Bridge	Structural Concrete Bridge/Ret Walls
	Concrete Structural	Structural Concrete Miscellaneous
✓	Curb & Walks	Concrete Curbs & Gutter
✓	Curb & Walks	Concrete Walks
	Earth Retention	Engineering for Sheet piling, Shoring
	Earth Retention	H- Piles
	Earth Retention	Sheet Piling
	Earth Retention	Shoring & Sheet Piling
✓	Earthwork	Dewatering
✓	Earthwork	Crushing Of Recycled Aggregates
	Earthwork	Hydraulic Excavation
✓	Earthwork	Supply of Granular & Aggregates
	Electrical	Electrical Airport Related
✓	Electrical	Electrical Lighting
✓	Electrical	Electrical Signal
✓	Electrical	Loop Detectors
✓	Electrical	Supplies of Electrical Materials
✓	Environmental	Environmental testing and Consulting
✓	Environmental	Haul & Dispose Contaminated Soils
	Environmental	Haul & Dispose Impacted Soils
✓	Erosion Control	Erosion Control- Permanent
✓	Erosion Control	Erosion Control- Temporary
✓	Erosion Control	Hydroseeding Temp
✓	Fencing	Fencing / Bollards
✓	Field Engineering	As- Built Surveys
✓	Field Engineering	Surveying
✓	Guardrail	Guardrail
✓	Milling	Bituminous Milling
	Misc	Boardwalks, Decks, Woodwork
✓	Misc	Clean up Vac Trucks
✓	Misc	Flagging- Highway Work
✓	Misc	Lumber Supplies
	Misc	Pilot Car- Airport Secured Area
✓	Misc	Field Office
	Asbestos	Asbestos Abatement

	<b>Categories</b>	<b>Description of Work</b>
	Misc	Pilot Car- Highway Work
✓	Misc	Port-a-Potys
	Misc	Radio Car- Airport Secured Area
✓	Misc	Site Amenities, Benches, Kiosks
✓	Misc	Supplies of Misc Construction Materials
✓	Misc	Sweeping- Pickup Brooms
✓	Ornamental	Ornamental Steel
✓	Pavement Markings	Epoxy- Pavement Markings
✓	Pavement Markings	Paint- Pavement Markings
✓	Pavement Markings	Poly- Pavement Markings
✓	Pavement Markings	Thermo- Pavement Markings
✓	Paving	Asphalt Paving
✓	Paving	Supplies of Asphalt Materials
	Retaining Walls	Soil Retention Walls
✓	Retaining Walls	Mod Block Walls
✓	Saw & Seal	Joint Adhesives
✓	Saw & Seal	Saw & Seal Pavement
✓	Sawcutting	Sawcutting
✓	Signage	Permanent Sign Panels
✓	Site Utilities	Castings & Other Misc Structures
✓	Site Utilities	Drainage Structures
✓	Site Utilities	Sanitary
✓	Site Utilities	Storm Sewer
✓	Site Utilities	Watermain
✓	Steel	Fabricated Steel
✓	Subdrainage	Drain Tile
✓	Testing	Moisture & other Geotechnical Testing
✓	Traffic Control	J Barriers
✓	Traffic Control	Pavement Marking Removals
✓	Traffic Control	Temp Signage
✓	Traffic Control	Traffic Control
✓	Tree Clearing	Clear & Grub
✓	Trucking	Rubble
✓	Trucking	Aggregates, Misc Earth Materials
✓	Turf Establishment	Hydroseeding Permanent
✓	Turf Establishment	Seeding
✓	Turf Establishment	Sodding
✓	Landscaping	Trees, Plantings, Soils for Planting Medium

## SCOTT COUNTY HIGHWAY PROJECT

Bids Close June 1<sup>st</sup>, 2019

Jordan, Minnesota

Electronic bids will be received until **10:00 A.M., Saturday, June 1, 2019**, by the County Engineer, Scott County Highway Department, 600 County Trail E, Jordan, MN 55352, for construction of the following:

**SP 7001-127, SP 070-621-032, SP 201-101-006, SP 201-130-002**

**TH 13, CSAH 21, Arcadia Ave, Duluth Ave**

Major Items Include (approximate quantities listed):

ITEM	UNIT	QUANTITY
<b>ROADWAY:</b>		
REMOVE BITUMINOUS PAVEMENT	SQ YD	43140
GEOTEXTILE FABRIC TYPE 5	SQ YD	6611
GEOMEMBRANE SYSTEM	SQ YD	7132
GEOFOAM	CU YD	5200
HAUL AND DISPOSE OF CONTAMINATED MATERIAL	CU YD	700
EXCAVATION – COMMON (P)	CU YD	69941
SELECT GRANULAR EMBANKMENT (CV) (P)	CU YD	30707
SELECT GRANULAR EMBANKMENT SUPER SAND (CV) (P)	CU YD	2770
COMMON EMBANKMENT (CV) (P)	CU YD	17642
AGGREGATE BASE (CV) CLASS 5 (P)	CU YD	11337
AGGREGATE BASE (CV) CLASS 6 (P)	CU YD	6822
CONCRETE PAVEMENT 8.0"	SQ YD	635
TYPE SP 9.5 WEARING COURSE MIXTURE (2,B)	TON	1081
TYPE SP 12.5 WEARING COURSE MIXTURE (3,B)	TON	6169
TYPE SP 12.5 NON WEARING COURSE MIXTURE (3,F)	TON	9122
ORNAMENTAL METAL RAILING	LIN FT	438
PREFABRICATED MODULAR BLOCK WALL	SQ FT	5546
4" PERF PE PIPE DRAIN	LIN FT	9536
16" STEEL CASING PIPE	LIN FT	735
15" RC PIPE SEWER DES 3006 CL III	LIN FT	2764
8" WATERMAIN DUCTILE IRON CL 52	LIN FT	1150
CONST DRAINAGE STRUCTURE DES 48-4020	EACH	117
4" CONCRETE WALK	SQ FT	21021
6" CONCRETE WALK	SQ FT	14894
CONCRETE CURB & GUTTER DESIGN B424	LIN FT	6249
LIGHTING SYSTEM "A"	LUMP SUM	1
TRAFFIC BARRIER DESIGN TYPE 31	LIN FT	449
SIGN PANELS TYPE C	SQ FT	1267
TRAFFIC CONTROL INTERCONNECT	LUMP SUM	1
MAST ARM POLE AND FOUNDATION	EACH	4
ORNAMENTAL TREE 6' HT BR	TREE	18
TEMPORARY EROSION CONTROL	LUMP SUM	1
LOAM TOPSOIL BORROW	CU YD	1003
TURF REINFORCEMENT MAT CATEGORY 3	SY YD	2542
HYDRAULIC REINFORCED FIBER MATRIX	POUND	26773
4" SOLID LINE MULTI-COMPONENT GROUND IN (WR)	LIN FT	9690

## **BIDDERS PLEASE NOTE**

For **SP 7001-127, SP 070-621-032, SP 201-101-006 & SP 201-130-002**, all Plan, Proposal and Addendum related documents that have traditionally been provided in paper form (hard copy), are provided for and made available through electronic download over the internet at

**<https://egram.co.scott.mn.us>** (Look under Projects in Bidding).\*\*\*

The Plan, Proposal and Addendums may be examined at the Scott County Highway Department, 600 County Trail E, Jordan, MN 55352. Any copies of project documents will be available only through the internet website address provided above. \*\*\*

**\*\*\* ONLY REGISTERED PLANHOLDERS WILL BE ALLOWED TO BID ON PROJECTS.** There is no cost to register or download these project related Plan and Proposal documents. To become a registered planholder you must create an account on the internet at:

**<https://connex.mn.uccs.com>**

In order to access these documents online, contractors will need to have a ConneX account and have been granted access to the Scott County eGram server. Instructions on creating a ConneX account, requesting eGram access, and/or bidding on Scott County projects can be found by checking out the Scott County Electronic Bidding Guide on the county website:

**<http://www.scottcountymn.gov/1808/Roads-Transportation-Bidding-Information>**

The bidder is responsible for all present and future downloads of any and all project documents, including, but not limited to, addendums and their respective attachments. This in no way reduces your responsibility to strictly adhere to these specifications.

**BIDS WILL ONLY BE ACCEPTED BY SUBMITTING AN ELECTRONIC BID USING BIDVAULT (NO HARD COPY BIDS WILL BE ACCEPTED):**

**<https://bidvault.mn.uccs.com/>**

Instructions on submitting a bid electronically can be found in the Scott County Electronic Bidding Guide on the County website listed above.

**\*\* Prospective Bidders: Prior to submitting a bid, bidders are required to purchase bid credits from BidVault.**

Each bid shall be accompanied by a bidder's bond naming Scott County as obligee, certified check payable to the Scott County Treasurer or a cash deposit equal to at least five percent (5%) of the amount of the bid, which shall be forfeited to the County in the event that the bidder fails to enter into a contract.

The County reserves the right to retain the deposits of the three lowest bidders for a period not to exceed 60 days after the date and time set of the opening of bids. No bids may be withdrawn for a period of sixty (60) days after the date and time set of the opening of bids.

The Scott County Board of Commissioners reserves the right to reject any and all bids, to waive irregularities and informalities therein and further reserves the right to award the contract in the best interests of the County.



Minimum wage rates to be paid by the Contractors have been predetermined and are subject to the Work Hours Act of 1962, P.L. 87-581 and implementing regulations.

**READ CAREFULLY THE WAGE SCALES AND DIVISION A OF THE SPECIAL PROVISIONS AS THEY AFFECT THIS/THESE PROJECT/PROJECTS**

The Minnesota Department of Transportation hereby notifies all bidders:

in accordance with Title VI of the Civil Rights Act of 1964 (Act), as amended and Title 49, Code of Federal Regulations, Subtitle A Part 21, Non-discrimination in Federally-assisted programs of the Department of Transportation, it will affirmatively assure that in any contract entered into pursuant to this advertisement, disadvantaged business enterprises will be afforded maximum opportunity to participate and/or to submit bids in response to this invitation, and will not be discriminated against on the grounds of race, color, disability, age, religion, sex or national origin in consideration for an award;

in accordance with Title VI of the Civil Rights Act of 1964 as amended, and Title 23, Code of Federal Regulations, Part 230 Subpart A-Equal Employment Opportunity on Federal and Federal-Aid Construction Contracts (including supportive services), it will affirmatively assure increased participation of minority groups and disadvantaged persons and women in all phases of the highway construction industry, and that on any project constructed pursuant to this advertisement equal employment opportunity will be provided to all persons without regard to their race, color, disability, age, religion, sex or national origin;

in accordance with the Minnesota Human Rights Act, Minnesota Statute 363A.08 Unfair discriminatory Practices, it will affirmatively assure that on any project constructed pursuant to this advertisement equal employment opportunity will be offered to all persons without regard to race, color, creed, religion, national origin, sex, marital status, status with regard to public assistance, membership or activity in a local commission, disability, sexual orientation, or age; in accordance with the Minnesota Human Rights Act, Minnesota Statute 363A.36 Certificates of Compliance for Public Contracts, and 363A.37 Rules for Certificates of Compliance, it will assure that appropriate parties to any contract entered into pursuant to this advertisement possess valid Certificates of Compliance.

If you are not a current holder of a compliance certificate issued by the Minnesota Department of Human Rights and intend to bid on any job in this advertisement you must contact the Department of Human Rights immediately for assistance in obtaining a certificate.

The following notice from the Minnesota Department of Human Rights applies to all contractors:

"It is hereby agreed between the parties that Minnesota Statute, section 363A.36 and Minnesota Rules, parts 5000.3400 to 5000.3600 are incorporated into any contract between these parties based on this specification or any modification of it. A copy of Minnesota Statute 363A.36 and Minnesota Rules, parts 5000.3400 to 5000.3600 is available upon request from the contracting agency."

"It is hereby agreed between the parties that this agency will require affirmative action requirements be met by contractors in relation to Minnesota Statute 363A.36 and Minnesota Rules 5000.3600. Failure by a contractor to implement an affirmative action plan or make a good faith effort shall result in revocation of its certificate or revocation of the contract (Minnesota Statute 363A.36, Subd. 2 and 3)."

A minimum goal of 17.0% Good Faith Effort to be subcontracted to Disadvantaged Business Enterprises.

Dated May 6<sup>th</sup>, 2019

Scott County Auditor/Treasurer  
Courthouse  
200 4th Avenue West  
Shakopee, MN 55379

Tony Winiecki  
Scott County Engineer  
600 Country Trail East  
Jordan, MN 55352

Published in Belle Plaine Herald: May 8<sup>th</sup>, 15<sup>th</sup>, 22<sup>nd</sup>, 2019

Questions: contact Jake Balk, County Construction Program Manager at 952-496-8436 or  
[jbalk@co.scott.mn.us](mailto:jbalk@co.scott.mn.us)



## ⚠ WARNING

**THE BID CALCULATOR IS NOT INTEGRATED INTO BIDVAULT ONLINE BIDDING.  
TO ENTER BID VALUES INTO BIDVAULT, PLEASE LOOK FOR THIS PROJECT AT:  
[HTTPS://BIDVAULT.MN.UCCS.COM/PROJECT.PHP?ID=565](https://bidvault.mn.uccs.com/project.php?id=565)**

### Bid Calculator

1) Reload any bid values saved to a file on your computer.

 Browse... 

2) Enter/edit unit prices in Schedule of Prices below

#### Schedule of Prices

**Project SP 070-621-032** - Work Type: Roundabout

Title or Road Number: CSAH 21 at Trunk Highway 13 Roundabout

Line No.	Item No.	Description	Units	Quantity	Unit Price	Total Price
1	<a href="#">2011.601</a>	AS BUILT	LS	1	<input type="text" value="0"/>	\$0.00
2	<a href="#">2021.501</a>	MOBILIZATION	LS	1	<input type="text" value="0"/>	\$0.00
3	<a href="#">2031.502</a>	FIELD OFFICE TYPE D	EACH	1	<input type="text" value="0"/>	\$0.00
226	<a href="#">2041.610</a>	TRAINEE	HOUR	800	<input type="text" value="0"/>	\$0.00
227	<a href="#">2101.505</a>	GRUBBING	ACRE	1.9	<input type="text" value="0"/>	\$0.00
228	<a href="#">2101.524</a>	CLEARING	TREE	1	<input type="text" value="0"/>	\$0.00
4	<a href="#">2104.502</a>	REMOVE PIPE APRON	EACH	13	<input type="text" value="0"/>	\$0.00
5	<a href="#">2104.502</a>	REMOVE MISCELLANEOUS STRUCTURES	EACH	2	<input type="text" value="0"/>	\$0.00
6	<a href="#">2104.502</a>	REMOVE POST	EACH	8	<input type="text" value="0"/>	\$0.00
7	<a href="#">2104.502</a>	REMOVE MANHOLE	EACH	1	<input type="text" value="0"/>	\$0.00
8	<a href="#">2104.502</a>	REMOVE CASTING	EACH	7	<input type="text" value="0"/>	\$0.00
9	<a href="#">2104.502</a>	REMOVE HYDRANT	EACH	1	<input type="text" value="0"/>	\$0.00
10	<a href="#">2104.502</a>	REMOVE DRAINAGE STRUCTURE	EACH	60	<input type="text" value="0"/>	\$0.00
11	<a href="#">2104.502</a>	REMOVE DELINEATOR	EACH	4	<input type="text" value="0"/>	\$0.00

12	<a href="#">2104.502</a>	REMOVE MARKER	EACH	15	0	\$0.00
13	<a href="#">2104.502</a>	REMOVE SIGN TYPE C	EACH	103	0	\$0.00
14	<a href="#">2104.502</a>	REMOVE SIGN TYPE D	EACH	4	0	\$0.00
15	<a href="#">2104.502</a>	REMOVE SIGNAL SYSTEM A	EACH	1	0	\$0.00
16	<a href="#">2104.502</a>	REMOVE SIGNAL SYSTEM B	EACH	1	0	\$0.00
17	<a href="#">2104.502</a>	REMOVE ENERGY ABSORBING TERMINAL	EACH	4	0	\$0.00
229	<a href="#">2104.502</a>	SALVAGE LIGHTING UNIT	EACH	1	0	\$0.00
18	<a href="#">2104.502</a>	SALVAGE SIGN	EACH	3	0	\$0.00
19	<a href="#">2104.502</a>	SALVAGE SIGN TYPE D	EACH	2	0	\$0.00
20	<a href="#">2104.502</a>	SALVAGE SIGN TYPE SPECIAL	EACH	18	0	\$0.00
21	<a href="#">2104.503</a>	SAWING CONCRETE PAVEMENT (FULL DEPTH)	L F	37	0	\$0.00
230	<a href="#">2104.503</a>	SAWING BIT PAVEMENT (FULL DEPTH)	L F	2951	0	\$0.00
22	<a href="#">2104.503</a>	REMOVE WATER MAIN	L F	1286	0	\$0.00
23	<a href="#">2104.503</a>	REMOVE SEWER PIPE (STORM)	L F	3499	0	\$0.00
24	<a href="#">2104.503</a>	REMOVE SEWER PIPE (SANITARY)	L F	685	0	\$0.00
25	<a href="#">2104.503</a>	REMOVE CURB & GUTTER	L F	12178	0	\$0.00
26	<a href="#">2104.503</a>	REMOVE WOOD RETAINING WALL	L F	298	0	\$0.00
242	<a href="#">2104.503</a>	REMOVE CHAIN LINK FENCE	L F	155	0	\$0.00
27	<a href="#">2104.503</a>	REMOVE GUARDRAIL-PLATE BEAM	L F	983	0	\$0.00
28	<a href="#">2104.504</a>	REMOVE CONCRETE WALK	S Y	4253	0	\$0.00
29	<a href="#">2104.504</a>	REMOVE BITUMINOUS PAVEMENT	S Y	43140	0	\$0.00
30	<a href="#">2104.518</a>	REMOVE BITUMINOUS WALK	S F	43322	0	\$0.00
31	<a href="#">2104.518</a>	REMOVE CONCRETE DRIVEWAY PAVEMENT	S F	864	0	\$0.00

32	<a href="#">2104.518</a>	REMOVE CONCRETE MEDIAN	S F	22984	0	\$0.00
33	<a href="#">2104.601</a>	HAUL SALVAGED MATERIAL	LS	1	0	\$0.00
243	<a href="#">2104.618</a>	REMOVE AND REPLACE BITUMINOUS PAVEMENT	S F	2782	0	\$0.00
34	<a href="#">2105.504</a>	GEOTEXTILE FABRIC TYPE 5	S Y	6611	0	\$0.00
35	<a href="#">2105.601</a>	DEWATERING	LS	1	0	\$0.00
36	<a href="#">2105.604</a>	GEOMEMBRANE SYSTEM	S Y	7132	0	\$0.00
231	<a href="#">2105.607</a>	EXCAVATION SPECIAL	C Y	700	0	\$0.00
37	<a href="#">2105.607</a>	GEOFOAM	C Y	5200	0	\$0.00
38	<a href="#">2105.607</a>	HAUL & DISPOSE OF CONTAMINATED MATERIAL	C Y	1200	0	\$0.00
39	<a href="#">2106.507</a>	EXCAVATION - COMMON	C Y	69941	0	\$0.00
40	<a href="#">2106.507</a>	SELECT GRANULAR EMBANKMENT (CV)	C Y	30707	0	\$0.00
232	<a href="#">2106.507</a>	SELECT GRANULAR EMBANK SUPER SAND (CV)	C Y	2770	0	\$0.00
41	<a href="#">2106.507</a>	COMMON EMBANKMENT (CV)	C Y	17642	0	\$0.00
42	<a href="#">2118.507</a>	AGGREGATE SURFACING (CV) CLASS 2	C Y	146	0	\$0.00
43	<a href="#">2211.507</a>	AGGREGATE BASE (CV) CLASS 5	C Y	11337	0	\$0.00
44	<a href="#">2211.507</a>	AGGREGATE BASE (CV) CLASS 6	C Y	6822	0	\$0.00
46	<a href="#">2231.509</a>	BITUMINOUS PATCHING MIXTURE	TON	20	0	\$0.00
45	<a href="#">2232.504</a>	MILL BITUMINOUS SURFACE (1.5")	S Y	3352	0	\$0.00
47	<a href="#">2301.504</a>	CONCRETE PAVEMENT 8.0"	S Y	635	0	\$0.00
48	<a href="#">2301.602</a>	DRILL & GROUT DOWEL BAR (EPOXY COATED)	EACH	1925	0	\$0.00
49	<a href="#">2360.509</a>	TYPE SP 9.5 WEARING COURSE MIX (2;B)	TON	1081	0	\$0.00
50	<a href="#">2360.509</a>		TON	6169	0	\$0.00

		TYPE SP 12.5 NON WEAR COURSE MIX (3;B)				
51	<a href="#">2360.509</a>	TYPE SP 12.5 WEARING COURSE MIX (3;F)	TON	9122	0	\$0.00
52	<a href="#">2402.503</a>	ORNAMENTAL METAL RAILING	L F	438	0	\$0.00
53	<a href="#">2402.503</a>	ORNAMENTAL METAL RAILING TYPE SPECIAL	L F	190	0	\$0.00
54	<a href="#">2411.507</a>	STRUCTURAL CONCRETE (1G52)	C Y	9	0	\$0.00
233	<a href="#">2411.507</a>	AGGREGATE BACKFILL (CV)	C Y	11	0	\$0.00
244	<a href="#">2411.508</a>	REINFORCEMENT BARS	LB	1235	0	\$0.00
55	<a href="#">2411.603</a>	CONCRETE PLANTER WALL	L F	86	0	\$0.00
56	<a href="#">2411.618</a>	PREFABRICATED MODULAR BLOCK WALL	S F	5546	0	\$0.00
57	<a href="#">2411.618</a>	SPECIAL SURFACE FINISH	S F	55438	0	\$0.00
58	<a href="#">2451.507</a>	FINE AGGREGATE BEDDING (CV)	C Y	133	0	\$0.00
59	<a href="#">2501.502</a>	15" RC PIPE APRON	EACH	1	0	\$0.00
60	<a href="#">2501.502</a>	24" RC PIPE APRON	EACH	1	0	\$0.00
61	<a href="#">2501.502</a>	30" RC PIPE APRON	EACH	1	0	\$0.00
62	<a href="#">2501.502</a>	36" RC PIPE APRON	EACH	3	0	\$0.00
63	<a href="#">2501.502</a>	36" SPAN RC PIPE-ARCH APRON	EACH	2	0	\$0.00
64	<a href="#">2501.502</a>	15" RC SAFETY APRON	EACH	2	0	\$0.00
65	<a href="#">2501.502</a>	24" RC SAFETY APRON	EACH	2	0	\$0.00
66	<a href="#">2501.503</a>	36" SPAN RC PIPE-ARCH CULV CL IIA	L F	34	0	\$0.00
67	<a href="#">2501.503</a>	36" RC PIPE CULVERT DES 3006 CL V	L F	123	0	\$0.00
68	<a href="#">2502.503</a>	4" PERF TP PIPE DRAIN	L F	9536	0	\$0.00
69	<a href="#">2503.503</a>	8" PVC PIPE SEWER	L F	783	0	\$0.00
245	<a href="#">2503.503</a>	12" RC PIPE SEWER CLASS III	L F	46	0	\$0.00

234	<a href="#">2503.503</a>	15" RC PIPE SEWER DES 3006 CL III	L F	2764	0	\$0.00
70	<a href="#">2503.503</a>	15" RC PIPE SEWER DES 3006 CL V	L F	46	0	\$0.00
235	<a href="#">2503.503</a>	18" RC PIPE SEWER DES 3006 CL III	L F	658	0	\$0.00
71	<a href="#">2503.503</a>	18" RC PIPE SEWER DES 3006 CL V	L F	195	0	\$0.00
236	<a href="#">2503.503</a>	21" RC PIPE SEWER DES 3006 CL III	L F	26	0	\$0.00
72	<a href="#">2503.503</a>	24" RC PIPE SEWER DES 3006 CL III	L F	744	0	\$0.00
73	<a href="#">2503.503</a>	24" RC PIPE SEWER DES 3006 CL V	L F	83	0	\$0.00
74	<a href="#">2503.503</a>	30" RC PIPE SEWER DES 3006 CL III	L F	284	0	\$0.00
75	<a href="#">2503.503</a>	36" RC PIPE SEWER DES 3006 CL III	L F	317	0	\$0.00
217	<a href="#">2503.601</a>	BYPASS PUMPING SANITARY SEWER	LUMP SUM	1	0	\$0.00
76	<a href="#">2503.602</a>	CONNECT TO EXISTING MANHOLES (SAN)	EACH	4	0	\$0.00
77	<a href="#">2503.602</a>	CONNECT TO EXISTING STORM SEWER	EACH	33	0	\$0.00
78	<a href="#">2503.603</a>	LINING SEWER PIPE 24"	L F	873	0	\$0.00
79	<a href="#">2503.603</a>	16" SPLIT STEEL CASING PIPE	L F	80	0	\$0.00
80	<a href="#">2503.603</a>	16" STEEL CASING PIPE	L F	210	0	\$0.00
81	<a href="#">2503.603</a>	15" HDPE PIPE SEWER	L F	227	0	\$0.00
82	<a href="#">2504.601</a>	IRRIGATION SYSTEM	LS	1	0	\$0.00
83	<a href="#">2504.602</a>	CONNECT TO EXISTING WATER MAIN	EACH	8	0	\$0.00
84	<a href="#">2504.602</a>	CONNECT TO EXISTING WATER SERVICE	EACH	1	0	\$0.00
85	<a href="#">2504.602</a>	HYDRANT	EACH	1	0	\$0.00
86	<a href="#">2504.602</a>	ADJUST VALVE BOX-WATER	EACH	2	0	\$0.00

87	<a href="#">2504.602</a>	1" CORPORATION STOP	EACH	3	0	\$0.00
88	<a href="#">2504.602</a>	2" CORPORATION STOP	EACH	1	0	\$0.00
89	<a href="#">2504.602</a>	6" GATE VALVE & BOX	EACH	6	0	\$0.00
90	<a href="#">2504.602</a>	8" GATE VALVE & BOX	EACH	5	0	\$0.00
91	<a href="#">2504.602</a>	12" GATE VALVE & BOX	EACH	1	0	\$0.00
92	<a href="#">2504.602</a>	1" CURB STOP & BOX	EACH	3	0	\$0.00
93	<a href="#">2504.602</a>	2" CURB STOP & BOX	EACH	1	0	\$0.00
94	<a href="#">2504.603</a>	1" TYPE K COPPER PIPE	L F	43	0	\$0.00
95	<a href="#">2504.603</a>	2" TYPE K COPPER PIPE	L F	285	0	\$0.00
96	<a href="#">2504.603</a>	6" WATERMAIN DUCTILE IRON CL 52	L F	78	0	\$0.00
97	<a href="#">2504.603</a>	8" WATERMAIN DUCTILE IRON CL 52	L F	1150	0	\$0.00
98	<a href="#">2504.603</a>	12" WATERMAIN DUCTILE IRON CL 52	L F	13	0	\$0.00
238	<a href="#">2504.603</a>	16" STEEL CASING PIPE	L F	525	0	\$0.00
237	<a href="#">2504.603</a>	16" SPLIT STEEL CASING PIPE	L F	50	0	\$0.00
99	<a href="#">2504.604</a>	4" POLYSTYRENE INSULATION	S Y	38	0	\$0.00
100	<a href="#">2504.608</a>	WATERMAIN FITTINGS	LB	1112	0	\$0.00
101	<a href="#">2506.502</a>	CONST DRAINAGE STRUCTURE DESIGN SPECIAL	EACH	2	0	\$0.00
102	<a href="#">2506.502</a>	CONSTRUCT DRAINAGE STRUCTURE DES 4007	EACH	5	0	\$0.00
103	<a href="#">2506.502</a>	CONST DRAINAGE STRUCTURE DES 48-4020	EACH	117	0	\$0.00
104	<a href="#">2506.502</a>	CONST DRAINAGE STRUCTURE DES 60-4020	EACH	16	0	\$0.00
105	<a href="#">2506.502</a>	CONST DRAINAGE STRUCTURE DES 72-4020	EACH	11	0	\$0.00
106	<a href="#">2506.502</a>	CONST DRAINAGE STRUCTURE DES 84-4020	EACH	2	0	\$0.00

107	<a href="#">2506.502</a>	CONST DRAINAGE STRUCTURE DES 108-4020	EACH	1	0	\$0.00
108	<a href="#">2506.502</a>	CASTING ASSEMBLY	EACH	6	0	\$0.00
109	<a href="#">2506.502</a>	ADJUST FRAME & RING CASTING	EACH	15	0	\$0.00
110	<a href="#">2506.601</a>	INFILTRATION/FILTRATION SYSTEM	LS	1	0	\$0.00
221	<a href="#">2506.602</a>	STRUCTURAL POLLUTION CONTROL DEVICE	EACH	5	0	\$0.00
219	<a href="#">2506.602</a>	CONST DRAINAGE STRUCTURE DESIGN SD-48	EACH	5	0	\$0.00
111	<a href="#">2506.602</a>	RECONSTRUCT DRAINAGE STRUCTURE	EACH	3	0	\$0.00
112	<a href="#">2506.602</a>	CONNECT INTO EXISTING DRAINAGE STRUCTURE	EACH	14	0	\$0.00
220	<a href="#">2506.602</a>	MANHOLE JOINT SEAL	EACH	9	0	\$0.00
218	<a href="#">2506.602</a>	CASTING ASSEMBLY SPECIAL	EACH	2	0	\$0.00
113	<a href="#">2506.602</a>	ADJUST FRAME & RING CASTING (SPECIAL)	EACH	5	0	\$0.00
222	<a href="#">2506.606</a>	MISCELLANEOUS GROUT	GALLON	15	0	\$0.00
114	<a href="#">2511.504</a>	GEOTEXTILE FILTER TYPE 4	S Y	329	0	\$0.00
115	<a href="#">2511.507</a>	RANDOM RIPRAP CLASS III	C Y	128	0	\$0.00
239	<a href="#">2511.507</a>	GRANULAR FILTER	C Y	11	0	\$0.00
116	<a href="#">2511.607</a>	GRANULAR BEDDING SPECIAL	C Y	25	0	\$0.00
117	<a href="#">2520.507</a>	LEAN MIX BACKFILL	C Y	124	0	\$0.00
118	<a href="#">2521.518</a>	4" CONCRETE WALK	S F	21021	0	\$0.00
119	<a href="#">2521.518</a>	4" CONCRETE WALK SPECIAL	S F	2051	0	\$0.00
120	<a href="#">2521.518</a>	4" CONCRETE WALK SPECIAL 1	S F	1850	0	\$0.00
121	<a href="#">2521.518</a>	6" CONCRETE WALK	S F	14894	0	\$0.00
240	<a href="#">2521.518</a>	7" CONCRETE WALK- REINFORCED	S F	1579	0	\$0.00



122	<a href="#">2531.503</a>	CONCRETE CURB & GUTTER DESIGN B412 (MOD)	L F	4420	0	\$0.00
123	<a href="#">2531.503</a>	CONCRETE CURB & GUTTER DESIGN B424	L F	6249	0	\$0.00
124	<a href="#">2531.503</a>	CONCRETE CURB & GUTTER DESIGN B424 (MOD)	L F	3488	0	\$0.00
125	<a href="#">2531.503</a>	CONCRETE CURB & GUTTER DESIGN B612	L F	427	0	\$0.00
126	<a href="#">2531.503</a>	CONCRETE CURB & GUTTER DESIGN B618	L F	2750	0	\$0.00
127	<a href="#">2531.503</a>	CONCRETE CURB & GUTTER DESIGN R424	L F	634	0	\$0.00
128	<a href="#">2531.503</a>	CONCRETE CURB & GUTTER DESIGN S512	L F	3968	0	\$0.00
129	<a href="#">2531.503</a>	CONCRETE CURB & GUTTER DESIGN S524	L F	2350	0	\$0.00
130	<a href="#">2531.503</a>	CONCRETE CURB & GUTTER DESIGN V924	L F	1683	0	\$0.00
131	<a href="#">2531.504</a>	CONCRETE MEDIAN	S Y	2975	0	\$0.00
132	<a href="#">2531.504</a>	8" CONCRETE DRIVEWAY PAVEMENT	S Y	66	0	\$0.00
223	<a href="#">2531.604</a>	10" CONCRETE VALLEY GUTTER	S Y	97	0	\$0.00
133	<a href="#">2531.618</a>	TRUNCATED DOMES	S F	1554	0	\$0.00
134	<a href="#">2540.602</a>	KIOSK	EACH	1	0	\$0.00
135	<a href="#">2540.602</a>	BOLLARD	EACH	54	0	\$0.00
136	<a href="#">2540.602</a>	ENTRY MONUMENT TYPE A	EACH	2	0	\$0.00
137	<a href="#">2540.602</a>	ENTRY MONUMENT TYPE B	EACH	1	0	\$0.00
138	<a href="#">2540.602</a>	STONE MONUMENT	EACH	10	0	\$0.00
139	<a href="#">2540.603</a>	LANDSCAPE EDGER	L F	369	0	\$0.00
140	<a href="#">2545.501</a>	LIGHTING SYSTEM "A"	LS	1	0	\$0.00
141	<a href="#">2545.501</a>	LIGHTING SYSTEM "B"	LS	1	0	\$0.00
224	<a href="#">2545.501</a>	LIGHTING SYSTEM "C2"	LS	1	0	\$0.00
142	<a href="#">2554.502</a>	GUIDE POST TYPE B	EACH	12	0	\$0.00

143	<a href="#">2554.502</a>	ANCHORAGE ASSEMBLY - TYPE 31	EACH	1	0	\$0.00
144	<a href="#">2554.502</a>	END TREATMENT-TANGENT TERMINAL	EACH	1	0	\$0.00
145	<a href="#">2554.503</a>	TRAFFIC BARRIER DESIGN TYPE 31	L F	449	0	\$0.00
146	<a href="#">2563.601</a>	TRAFFIC CONTROL SUPERVISOR	LS	1	0	\$0.00
147	<a href="#">2563.601</a>	TRAFFIC CONTROL	LS	1	0	\$0.00
148	<a href="#">2563.601</a>	ALTERNATE PEDESTRIAN ROUTE	LS	1	0	\$0.00
149	<a href="#">2563.602</a>	RAISED PAVEMENT MARKER TEMPORARY	EACH	270	0	\$0.00
150	<a href="#">2563.602</a>	TUBE DELINEATOR	EACH	16	0	\$0.00
151	<a href="#">2563.602</a>	REPLACE TUBE DELINEATOR	EACH	32	0	\$0.00
152	<a href="#">2563.613</a>	PORTABLE CHANGEABLE MESSAGE SIGN	UDAY	126	0	\$0.00
153	<a href="#">2563.618</a>	CONSTRUCTION SIGN- SPECIAL	S F	250	0	\$0.00
154	<a href="#">2564.502</a>	INSTALL SIGN TYPE D	EACH	2	0	\$0.00
155	<a href="#">2564.502</a>	OVERHEAD SIGN IDENTIFICATION PLATE	EACH	2	0	\$0.00
156	<a href="#">2564.502</a>	DELINEATOR TYPE X4-13	EACH	2	0	\$0.00
157	<a href="#">2564.502</a>	OBJECT MARKER TYPE X4-2	EACH	8	0	\$0.00
158	<a href="#">2564.502</a>	OBJECT MARKER TYPE X4-4	EACH	1	0	\$0.00
159	<a href="#">2564.502</a>	OBJECT MARKER TYPE X4-5	EACH	3	0	\$0.00
160	<a href="#">2564.518</a>	SIGN PANELS TYPE C	S F	1267	0	\$0.00
161	<a href="#">2564.518</a>	SIGN PANELS TYPE D	S F	71	0	\$0.00
162	<a href="#">2564.518</a>	SIGN PANELS TYPE OH	S F	106	0	\$0.00
163	<a href="#">2564.518</a>	SIGN PANELS TYPE SPECIAL	S F	35	0	\$0.00
164	<a href="#">2564.602</a>	INSTALL SIGN	EACH	3	0	\$0.00
165	<a href="#">2564.602</a>	INSTALL SIGN TYPE SPECIAL	EACH	7	0	\$0.00
166	<a href="#">2565.501</a>		LS	1	0	\$0.00

		TRAFFIC CONTROL INTERCONNECT				
167	<a href="#">2565.602</a>	PEDESTAL POLE & BASE	EACH	1	0	\$0.00
168	<a href="#">2565.602</a>	MAST ARM POLE & FOUNDATION	EACH	4	0	\$0.00
169	<a href="#">2565.616</a>	PEDESTRIAN CROSSWALK FLASHER SYSTEM	SYS	1	0	\$0.00
170	<a href="#">2565.616</a>	REVISE SIGNAL SYSTEM C	SYS	1	0	\$0.00
171	<a href="#">2571.524</a>	DECIDUOUS TREE 2.5" CAL B&B	TREE	20	0	\$0.00
172	<a href="#">2571.524</a>	ORNAMENTAL TREE 6' HT B&B	TREE	18	0	\$0.00
173	<a href="#">2571.525</a>	CONIFEROUS SHRUB 3' HT CONT	SHRB	80	0	\$0.00
174	<a href="#">2571.525</a>	DECIDUOUS SHRUB NO 5 CONT	SHRB	194	0	\$0.00
175	<a href="#">2571.527</a>	PERENNIAL NO 1 CONT	PLT	767	0	\$0.00
176	<a href="#">2571.527</a>	ORNAMENTAL GRASS NO 1 CONT	PLT	984	0	\$0.00
177	<a href="#">2572.503</a>	TEMPORARY FENCE	L F	710	0	\$0.00
178	<a href="#">2572.503</a>	CLEAN ROOT CUTTING	L F	488	0	\$0.00
179	<a href="#">2573.501</a>	EROSION CONTROL SUPERVISOR	LS	1	0	\$0.00
180	<a href="#">2573.601</a>	TEMPORARY EROSION CONTROL	LS	1	0	\$0.00
181	<a href="#">2574.505</a>	SOIL BED PREPARATION	ACRE	7.29	0	\$0.00
182	<a href="#">2574.507</a>	LOAM TOPSOIL BORROW	C Y	1003	0	\$0.00
241	<a href="#">2574.507</a>	COMPOST GRADE 2	C Y	1949	0	\$0.00
183	<a href="#">2574.508</a>	FERTILIZER TYPE 3	LB	1956	0	\$0.00
184	<a href="#">2575.504</a>	TURF REINFORCEMENT MAT CATEGORY 3	S Y	2542	0	\$0.00
185	<a href="#">2575.505</a>	SEEDING	ACRE	7.29	0	\$0.00
186	<a href="#">2575.505</a>	MOWING	ACRE	14.58	0	\$0.00
187	<a href="#">2575.505</a>	WEED SPRAYING	ACRE	3.65	0	\$0.00

188	<a href="#">2575.506</a>	WEED SPRAY MIXTURE	GAL	1.95	0	\$0.00
189	<a href="#">2575.507</a>	MULCH MATERIAL TYPE 6	C Y	167	0	\$0.00
190	<a href="#">2575.508</a>	SEED MIXTURE 25-151	LB	411	0	\$0.00
191	<a href="#">2575.508</a>	SEED MIXTURE 33-261	LB	23	0	\$0.00
192	<a href="#">2575.508</a>	SEED MIXTURE 35-241	LB	121	0	\$0.00
193	<a href="#">2575.508</a>	HYDRAULIC REINFORCED FIBER MATRIX	LB	26773	0	\$0.00
194	<a href="#">2575.605</a>	SEEDING SPECIAL	ACRE	0.11	0	\$0.00
195	<a href="#">2575.607</a>	LANDSCAPE ROCK	C Y	28	0	\$0.00
196	<a href="#">2580.503</a>	INTERIM PAVEMENT MARKING	L F	2870	0	\$0.00
197	<a href="#">2581.503</a>	REMOVABLE PREFORM PAVEMENT MARKING TAPE	L F	4075	0	\$0.00
198	<a href="#">2581.603</a>	REMOVABLE PREFORMED PLASTIC MASK (BLACK)	L F	1010	0	\$0.00
199	<a href="#">2581.618</a>	REMOVABLE PREFORMED PAVEMENT MESSAGE TAPE	S F	78	0	\$0.00
200	<a href="#">2582.503</a>	4" SOLID LINE PAINT	L F	14040	0	\$0.00
201	<a href="#">2582.503</a>	8" SOLID LINE PAINT	L F	795	0	\$0.00
202	<a href="#">2582.503</a>	24" SOLID LINE PAINT	L F	115	0	\$0.00
203	<a href="#">2582.503</a>	4" BROKEN LINE PAINT	L F	1340	0	\$0.00
204	<a href="#">2582.503</a>	4" DOTTED LINE PAINT	L F	190	0	\$0.00
205	<a href="#">2582.503</a>	4" DBLE SOLID LINE PAINT	L F	1015	0	\$0.00
206	<a href="#">2582.503</a>	4" SOLID LINE MULTI COMP	L F	825	0	\$0.00
207	<a href="#">2582.503</a>	4" DBLE SOLID LINE MULTI COMP	L F	230	0	\$0.00
208	<a href="#">2582.503</a>	24" SOLID LINE MULTI COMP GR IN	L F	70	0	\$0.00
209	<a href="#">2582.503</a>	4" SOLID LINE MULTI COMP GR IN (WR)	L F	9690	0	\$0.00
210	<a href="#">2582.503</a>	24" SOLID LINE MULTI COMP GR IN (WR)	L F	460	0	\$0.00
211	<a href="#">2582.503</a>		L F	160	0	\$0.00

		4" DOTTED LINE MULTI COMP GR IN (WR)				
212	<a href="#">2582.503</a>	4" DBLE SOLID LINE MULTI COMP GR IN (WR)	L F	240	<input type="text" value="0"/>	\$0.00
225	<a href="#">2582.503</a>	12" DOTTED LINE PREF THERMO GR IN (WR)	L F	230	<input type="text" value="0"/>	\$0.00
213	<a href="#">2582.518</a>	PAVT MSSG PAINT	S F	599	<input type="text" value="0"/>	\$0.00
214	<a href="#">2582.518</a>	PAVT MSSG PREF THERMO GR IN	S F	313	<input type="text" value="0"/>	\$0.00
215	<a href="#">2582.518</a>	CROSSWALK PREF THERMO GR IN	S F	4229	<input type="text" value="0"/>	\$0.00
216	<a href="#">2582.603</a>	MOBILE RETROREFLECTOMETER MEASUREMENTS	L F	9930	<input type="text" value="0"/>	\$0.00
<b>Bid - Total</b>						<b>\$0.00</b>

### Addenda

Project	Addendum	Date Received
SP 070-621-032	Addendum 1 - 05/28/2019	

### Bidder Information

Name:	<input type="text"/>	Phone:	<input type="text"/>
Address:	<input type="text"/>	Email:	<input type="text"/>
	<input type="text"/>	Other:	<input type="text"/>
Signature:	<input type="text"/>	Date:	<input type="text"/>

3) Recalculate totals

4) Save unit prices to a file on your computer

5) View printer friendly version