



REQUEST FOR QUOTES

- ❖ **Project Name:** Mpls Event 3034 Johnson St NE & 35W Reconstruction
- ❖ **Project#:** SP#: 141-183-014 / Federal Proj #: CMAQ 2724(119)/Local Proj#: LP 600D10053
- ❖ **Bid Date/Time:** April 30th, 2024 @ 2:00pm
- ❖ **Bid Docs:** <https://meyerci.sharefile.com/public/share/web-s956f5860fd6845c99af021be10172587>

Work Scopes Needed:

Asbuilts	Traffic Control	Sawcutting	Milling/Reclaim
Asphalt Paving	Concrete Flatwork	Electrical	Landscape/Erosion Control
Pavement Marking	SUPPLIER: Aggregate	SUPPLIER: PVC/DIP	SUPPLIER: RCP/Precast

 Submit Quotes To: estimating@meyerci.com 

Project Description: 20.9 % DBE goal

DBE Directory. A directory of all certified DBEs in the state of Minnesota is available at the following link: <http://mnucp.metc.state.mn.us/Default.aspx> The Minnesota Unified Certification Program (MnUCP) maintains this directory. It is the definitive source of information regarding the DBE certification status of firms in Minnesota.

Class of Work: _____

Intersection Improvements

If you need assistance in obtaining bonding, lines of credit, insurance or would like assistance obtaining necessary equipment, supplies, materials, or any other related assistance, please contact Project Manager/Estimator, Josh Lindquist at (763) 391-5972 or estimating@meyerci.com

Meyer Contracting is an Equal Opportunity/Affirmative Action Employer. Minorities, women, disabled, and veterans are encouraged to apply for available openings.

11000 93rd Ave N • Maple Grove, MN 55369
Phone: 763.391.5959 • Fax: 763.391.5960 www.meyerci.com



REQUEST FOR QUOTES

Project Location(s):

FROM 175' SOUTH OF JOHNSON STREET NE TO NE. 18TH AVE.

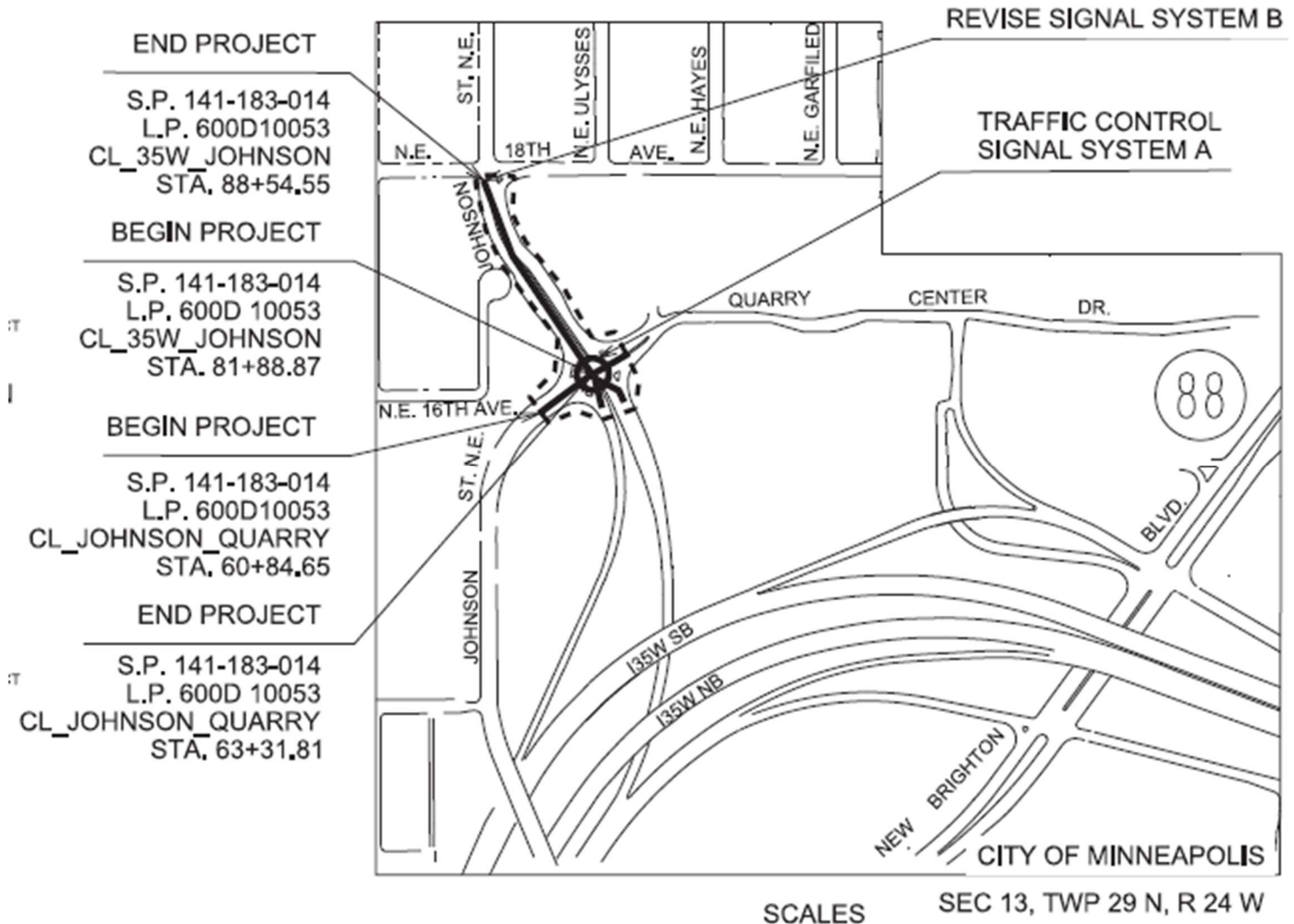

If you need assistance in obtaining bonding, lines of credit, insurance or would like assistance obtaining necessary equipment, supplies, materials, or any other related assistance, please contact Project Manager/Estimator, Josh Lindquist at (763) 391-5972 or estimating@meyerci.com

Meyer Contracting is an Equal Opportunity/Affirmative Action Employer. Minorities, women, disabled, and veterans are encouraged to apply for available openings.



REQUEST FOR QUOTES

UNIT PRICING

NO.	ITEM NO.	ITEM DESCRIPTION	UNIT	CONTRACT QUANTITY
1	2011.601	AS BUILT-MINNEAPOLIS	LUMP SUM	1.00
2	2021.501	MOBILIZATION	LUMP SUM	1.00
3	2102.518	PAVEMENT MARKING REMOVAL	SQ FT	30
4	2104.502	REMOVE MANHOLE	EACH	1
5	2104.502	REMOVE CASTING	EACH	6
6	2104.502	REMOVE VALVE BOX	EACH	1
7	2104.502	REMOVE HYDRANT	EACH	1
8	2104.502	REMOVE DRAINAGE STRUCTURE	EACH	10
9	2104.502	REMOVE SIGN	EACH	9
10	2104.502	REMOVE EXTRUDED SIGN PANEL	EACH	1
11	2104.502	REMOVE SIGN PANEL	EACH	6
12	2104.502	REMOVE SIGN PANEL SPECIAL	EACH	2
13	2104.502	SALVAGE SIGN PANEL	EACH	31
14	2104.502	SALVAGE BENCH	EACH	1
15	2104.503	SAWING CONCRETE PAVEMENT (FULL DEPTH)	LIN FT	85
16	2104.503	SAWING BITUMINOUS PAVEMENT (FULL DEPTH)	LIN FT	1777
17	2104.503	REMOVE WATER MAIN	LIN FT	10
18	2104.503	REMOVE SEWER PIPE (STORM)	LIN FT	244
19	2104.503	REMOVE CURB AND GUTTER	LIN FT	2075
20	2104.504	REMOVE CONCRETE WALK	SQ YD	1017
21	2104.504	REMOVE PAVEMENT	SQ YD	2150
22	2104.504	REMOVE CONCRETE PAVEMENT	SQ YD	152
23	2104.518	REMOVE BITUMINOUS WALK	SQ FT	447
24	2104.601	SALVAGE SIGNAL SYSTEM A	LUMP SUM	1
25	2106.507	EXCAVATION - COMMON	CU YD	452
26	2106.507	EXCAVATION - SUBGRADE	CU YD	750
27	2106.507	GRANULAR EMBANKMENT (CV)	CU YD	250
28	2106.507	SELECT GRANULAR EMBANKMENT (CV)	CU YD	500
29	2106.607	EXCAVATION SPECIAL	CU YD	250
30	2106.609	HAUL AND DISPOSE OF CONTAMINATED MATERIAL	TON	450
31	2108.504	GEOTEXTILE FABRIC TYPE 1	SQ YD	624

If you need assistance in obtaining bonding, lines of credit, insurance or would like assistance obtaining necessary equipment, supplies, materials, or any other related assistance, please contact Project Manager/Estimator, Josh Lindquist at (763) 391 or estimating@meyerci.com

Meyer Contracting is an Equal Opportunity/Affirmative Action Employer. Minorities, women, disabled, and veterans are encouraged to apply for available openings



REQUEST FOR QUOTES

UNIT PRICING

32	2123.610	STREET SWEEPER (WITH PICKUP BROOM)	HOUR	40
33	2130.523	WATER	M GALLON	1
34	2211.507	AGGREGATE BASE (CV) CLASS 5	CU YD	521
35	2232.504	MILL BITUMINOUS SURFACE (3.0")	SQ YD	2933
36	2232.504	MILL BITUMINOUS SURFACE (13.5")	SQ YD	2308
37	2360.509	TYPE SP 12.5 NON WEARING COURSE MIXTURE (4;L)	TON	1282
38	2360.509	TYPE SP 12.5 WEARING COURSE MIXTURE (5;L)	TON	1231
39	2481.618	MEMBRANE WATERPROOFING	SQ FT	450
40	2503.503	12" RC PIPE SEWER DESIGN 3006 CLASS V	LIN FT	200
41	2503.503	15" RC PIPE SEWER DESIGN 3006 CLASS V	LIN FT	99
42	2503.503	18" RC PIPE SEWER DESIGN 3006	LIN FT	12
43	2503.603	PLUG FILL AND ABANDON PIPE SEWER	LIN FT	125
44	2504.602	INSTALL HYDRANT	EACH	1
45	2504.602	VALVE BOX	EACH	1
46	2504.602	WATER UTILITY HOLE	EACH	2
47	2504.603	6" WATERMAIN DUCTILE IRON CL 52	LIN FT	33
48	2504.608	DUCTILE IRON FITTINGS	POUND	75
49	2506.502	CONSTRUCT DRAINAGE STRUCTURE DESIGN N	EACH	5
50	2506.502	CASTING ASSEMBLY	EACH	16
51	2506.503	CONSTRUCT DRAINAGE STRUCTURE DESIGN 48-4020	LIN FT	58.10
52	2506.503	RECONSTRUCT DRAINAGE STRUCTURE	LIN FT	5
53	2506.602	CONNECT INTO EXISTING DRAINAGE STRUCTURE	EACH	3
54	2506.602	CONNECT INTO EXISTING STORM SEWER	EACH	7
55	2506.602	ENERGY DISSIPATOR	EACH	5
56	2521.518	6" CONCRETE WALK	SQ FT	3940
57	2521.602	DRILL AND GROUT REINF BAR (EPOXY COATED)	EACH	155
58	2521.618	6" CONCRETE WALK SPECIAL - BLACK ICE	SQ FT	7119
59	2521.618	CONCRETE CURB RAMP WALK	SQ FT	728
60	2531.503	CONCRETE CURB AND GUTTER DESIGN B624	LIN FT	1999
61	2531.504	8" CONCRETE DRIVEWAY PAVEMENT	SQ YD	77
62	2531.504	8" CONCRETE DRIVEWAY PAVEMENT SPECIAL	SQ YD	49

If you need assistance in obtaining bonding, lines of credit, insurance or would like assistance obtaining necessary equipment, supplies, materials, or any other related assistance, please contact Project Manager/Estimator, Josh Lindquist at (763) 391 or estimating@meyerci.com

Meyer Contracting is an Equal Opportunity/Affirmative Action Employer. Minorities, women, disabled, and veterans are encouraged to apply for available openings



REQUEST FOR QUOTES

UNIT PRICING

63	2531.618	TRUNCATED DOMES	SQ FT	135
64	2533.503	PORTABLE PRECAST CONCRETE BARRIER DESIGN 8337	LIN FT	400
65	2533.503	RELOCATE PORTABLE PRECAST CONCRETE BARRIER DESIGN 8337	LIN FT	300
66	2540.602	INSTALL BENCH	EACH	1
67	2545.501	LIGHTING SYSTEM "A"	LUMP SUM	1
68	2550.502	SIGN FOUNDATION	EACH	16
69	2563.601	TRAFFIC CONTROL SUPERVISOR	LUMP SUM	1.00
70	2563.601	TRAFFIC CONTROL	LUMP SUM	1.00
71	2563.601	ALTERNATE PEDESTRIAN ROUTE	LUMP SUM	1.00
72	2564.502	INSTALL SIGN PANEL	EACH	31
73	2564.518	SIGN PANEL OVERLAY TYPE OH	SQ FT	22.50
74	2564.602	SIGN COLLAR	EACH	8
75	2564.618	SIGN	SQ FT	36.75
76	2564.618	SIGN PANEL	SQ FT	17.25
77	2564.618	SIGN PANEL SPECIAL	SQ FT	8.75
78	2564.618	EXTRUDED PANEL	SQ FT	22.50
79	2565.501	TRAFFIC CONTROL INTERCONNECT	LUMP SUM	1
80	2565.516	TRAFFIC CONTROL SIGNAL SYSTEM A	SYSTEM	1
81	2565.616	REVISE SIGNAL SYSTEM B	SYSTEM	1
82	2565.616	TEMPORARY SIGNAL SYSTEM	SYSTEM	1.0
83	2571.502	PERENNIAL 1 GAL CONT	EACH	887.00
84	2573.501	STABILIZED CONSTRUCTION EXIT	LUMP SUM	1.00
85	2573.501	EROSION CONTROL SUPERVISOR	LUMP SUM	1.00
86	2573.502	STORM DRAIN INLET PROTECTION	EACH	28
87	2573.503	SILT FENCE; TYPE MS	LIN FT	1087
88	2574.505	SOIL BED PREPARATION	ACRE	0.32
89	2574.507	FILTER TOPSOIL BORROW	CU YD	356
90	2574.507	BOULEVARD TOPSOIL BORROW	CU YD	290
91	2575.504	ROLLED EROSION PREVENTION CATEGORY 30	SQ YD	1937
92	2575.505	SEEDING	ACRE	0.32
93	2575.508	SEED MIXTURE 25-131	POUND	71
94	2575.508	HYDRAULIC MULCH MATRIX	POUND	672

If you need assistance in obtaining bonding, lines of credit, insurance or would like assistance obtaining necessary equipment, supplies, materials, or any other related assistance, please contact Project Manager/Estimator, Josh Lindquist at (763) 391 or estimating@meyerci.com

Meyer Contracting is an Equal Opportunity/Affirmative Action Employer. Minorities, women, disabled, and veterans are encouraged to apply for available openings



REQUEST FOR QUOTES

UNIT PRICING

95	2575.523	RAPID STABILIZATION METHOD 3	M GALLON	2.16
96	2575.608	SEED MIXTURE SPECIAL	POUND	1
97	2582.503	4" SOLID LINE MULTI-COMPONENT GROUND IN	LIN FT	1149
98	2582.503	8" SOLID LINE MULTI-COMPONENT GROUND IN	LIN FT	103
99	2582.503	4" BROKEN LINE MULTI-COMPONENT GROUND IN	LIN FT	204
100	2582.503	24" SOLID LINE PREFORM TAPE GROUND IN	LIN FT	170
101	2582.518	PAVEMENT MESSAGE PREFORM THERMOPLASTIC GROUND IN	SQ FT	155
102	2582.518	CROSSWALK PREFORM TAPE GROUND IN	SQ FT	690

If you need assistance in obtaining bonding, lines of credit, insurance or would like assistance obtaining necessary equipment, supplies, materials, or any other related assistance, please contact Project Manager/Estimator, Josh Lindquist at (763) 391 or estimating@meyerci.com

Meyer Contracting is an Equal Opportunity/Affirmative Action Employer. Minorities, women, disabled, and veterans are encouraged to apply for available openings